

## ELEVATION CERTIFICATE

**Important:** Follow the instructions on pages 1-9.

Copy all pages of this Elevation Certificate and all attachments for (1) community official, (2) insurance agent/company, and (3) building owner.

SECTION A - PROPERTY INFORMATION				FOR INSURANCE COMPANY USE	
A1. Building Owner's Name Becker Homes				Policy Number:	
A2. Building Street Address (including Apt., Unit, Suite, and/or Bldg. No.) or P.O. Route and Box No. 101 Silver Lake Way (per tax records)				Company NAIC Number:	
City Fayetteville		State Georgia		ZIP Code 30215	
A3. Property Description (Lot and Block Numbers, Tax Parcel Number, Legal Description, etc.) Lot 313, Waterlace Subdivision, Pod C, Plat Book 44, pages 49-65, Parcel ID = 070306007					
A4. Building Use (e.g., Residential, Non-Residential, Addition, Accessory, etc.) <u>Residential</u>					
A5. Latitude/Longitude: Lat. <u>33°26'7.86"N</u> Long. <u>84°31'46.11"W</u> Horizontal Datum: <input type="checkbox"/> NAD 1927 <input checked="" type="checkbox"/> NAD 1983					
A6. Attach at least 2 photographs of the building if the Certificate is being used to obtain flood insurance.					
A7. Building Diagram Number <u>8</u>					
A8. For a building with a crawlspace or enclosure(s):					
a) Square footage of crawlspace or enclosure(s) <u>295</u> sq ft					
b) Number of permanent flood openings in the crawlspace or enclosure(s) within 1.0 foot above adjacent grade <u>0</u>					
c) Total net area of flood openings in A8.b <u>0</u> sq in					
d) Engineered flood openings? <input type="checkbox"/> Yes <input checked="" type="checkbox"/> No					
A9. For a building with an attached garage:					
a) Square footage of attached garage <u>830</u> sq ft					
b) Number of permanent flood openings in the attached garage within 1.0 foot above adjacent grade <u>0</u>					
c) Total net area of flood openings in A9.b <u>0</u> sq in					
d) Engineered flood openings? <input type="checkbox"/> Yes <input checked="" type="checkbox"/> No					
SECTION B - FLOOD INSURANCE RATE MAP (FIRM) INFORMATION					
B1. NFIP Community Name & Community Number Fayette County, 130432			B2. County Name Fayette		B3. State Georgia
B4. Map/Panel Number 13113C0092	B5. Suffix E	B6. FIRM Index Date 09/26/2008	B7. FIRM Panel Effective/ Revised Date 09/26/2008	B8. Flood Zone(s) A	B9. Base Flood Elevation(s) (Zone AO, use Base Flood Depth) BFE = 872.18 (see comments)
B10. Indicate the source of the Base Flood Elevation (BFE) data or base flood depth entered in Item B9: <input type="checkbox"/> FIS Profile <input type="checkbox"/> FIRM <input type="checkbox"/> Community Determined <input checked="" type="checkbox"/> Other/Source: <u>Cert. of Flood Hazard Area Compliance (attached)</u>					
B11. Indicate elevation datum used for BFE in Item B9: <input type="checkbox"/> NGVD 1929 <input checked="" type="checkbox"/> NAVD 1988 <input type="checkbox"/> Other/Source: _____					
B12. Is the building located in a Coastal Barrier Resources System (CBRS) area or Otherwise Protected Area (OPA)? <input type="checkbox"/> Yes <input checked="" type="checkbox"/> No Designation Date: _____ <input type="checkbox"/> CBRS <input type="checkbox"/> OPA					

# ELEVATION CERTIFICATE

OMB No. 1660-0008  
Expiration Date: November 30, 2018

<b>IMPORTANT: In these spaces, copy the corresponding information from Section A.</b>			<b>FOR INSURANCE COMPANY USE</b>
Building Street Address (including Apt., Unit, Suite, and/or Bldg. No.) or P.O. Route and Box No. 101 Silver Lake Way (per tax records)			Policy Number:
City Fayetteville	State Georgia	ZIP Code 30215	Company NAIC Number

## SECTION C – BUILDING ELEVATION INFORMATION (SURVEY REQUIRED)

- C1. Building elevations are based on: ☐ Construction Drawings\* ☒ Building Under Construction\* ☐ Finished Construction  
\*A new Elevation Certificate will be required when construction of the building is complete.
- C2. Elevations – Zones A1–A30, AE, AH, A (with BFE), VE, V1–V30, V (with BFE), AR, AR/A, AR/AE, AR/A1–A30, AR/AH, AR/AO. Complete Items C2.a–h below according to the building diagram specified in Item A7. In Puerto Rico only, enter meters.  
Benchmark Utilized: Subdivision TBM (HW 318-319) Vertical Datum: NAVD 88  
Indicate elevation datum used for the elevations in items a) through h) below.  
☐ NGVD 1929 ☒ NAVD 1988 ☐ Other/Source: \_\_\_\_\_  
Datum used for building elevations must be the same as that used for the BFE.
- Check the measurement used.
- |   |              |  |
|---|--------------|--|
| a) Top of bottom floor (including basement, crawlspace, or enclosure floor)   | <u>874.9</u> | <input checked="" type="checkbox"/> feet <input type="checkbox"/> meters |
| b) Top of the next higher floor   | <u>882.9</u> | <input checked="" type="checkbox"/> feet <input type="checkbox"/> meters |
| c) Bottom of the lowest horizontal structural member (V Zones only)   | <u>N/A.</u>  | <input checked="" type="checkbox"/> feet <input type="checkbox"/> meters |
| d) Attached garage (top of slab)  | <u>882.1</u> | <input checked="" type="checkbox"/> feet <input type="checkbox"/> meters |
| e) Lowest elevation of machinery or equipment servicing the building<br>(Describe type of equipment and location in Comments) | <u>N/A.</u>  | <input checked="" type="checkbox"/> feet <input type="checkbox"/> meters |
| f) Lowest adjacent (finished) grade next to building (LAG)  | <u>874.9</u> | <input checked="" type="checkbox"/> feet <input type="checkbox"/> meters |
| g) Highest adjacent (finished) grade next to building (HAG)   | <u>881.8</u> | <input checked="" type="checkbox"/> feet <input type="checkbox"/> meters |
| h) Lowest adjacent grade at lowest elevation of deck or stairs, including structural support                                  | <u>N/A.</u>  | <input checked="" type="checkbox"/> feet <input type="checkbox"/> meters |

## SECTION D – SURVEYOR, ENGINEER, OR ARCHITECT CERTIFICATION

This certification is to be signed and sealed by a land surveyor, engineer, or architect authorized by law to certify elevation information. I certify that the information on this Certificate represents my best efforts to interpret the data available. I understand that any false statement may be punishable by fine or imprisonment under 18 U.S. Code, Section 1001.

Were latitude and longitude in Section A provided by a licensed land surveyor? ☒ Yes ☐ No ☒ Check here if attachments.

Certifier's Name Matthew Langley	License Number 3227
Title GA Registered Land Surveyor	
Company Name W.D. Gray and Associates, Inc.	
Address 160 Greencastle Road, Suite B	
City Tyrone	State Georgia
	ZIP Code 30290
Signature 	Date 08/25/2016
	Telephone (770) 486-7552

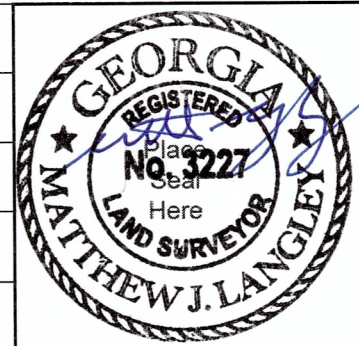

Copy all pages of this Elevation Certificate and all attachments for (1) community official, (2) insurance agent/company, and (3) building owner.

Comments (including type of equipment and location, per C2(e), if applicable)  
According to the referenced FIRM, a portion of this lot does lie within a special flood hazard area (Zone A). However, Per the Certificate of Flood Hazard Compliance issued by Fayette County Environmental Management and the referenced Final Plat of Waterlake, the base flood elevation is 872.18 and the required minimum finished floor elevation is 875.18. According to this information and the referenced subdivision benchmark, the lowest floor of this structure under construction lies above the base flood elevation but below the required minimum finished floor elevation. W.D. Gray and Associates, Inc. did not assist, provide input, or provide data to Fayette County in the establishment or determination of this minimum finished floor elevation. This structure is a residential house under construction. The latitude and longitude were computed using Google Earth. This certificate is NOT to be used to obtain flood insurance ratings.