

# ELEVATION CERTIFICATE

Important: Follow the instructions on pages 1-9.

Copy all pages of this Elevation Certificate and all attachments for (1) community official, (2) insurance agent/company, and (3) building owner.

SECTION A - PROPERTY INFORMATION		FOR INSURANCE COMPANY USE
A1. Building Owner's Name New Leaf Homes		Policy Number:
A2. Building Street Address (including Apt., Unit, Suite, and/or Bldg. No.) or P.O. Route and Box No. 190 Dockside Drive Tax Parcel 070337004		Company NAIC Number:
City Fayetteville	State Georgia	ZIP Code 30215
A3. Property Description (Lot and Block Numbers, Tax Parcel Number, Legal Description, etc.) Lot 386 Canoe Club @ Waterlace, Pod F, Plat Book 100, Page 294-306, Plat Book 100, pages 501-515		
A4. Building Use (e.g., Residential, Non-Residential, Addition, Accessory, etc.)		Residential
A5. Latitude/Longitude: Lat. 33°25'51.00"N Long. -084°31'12.53"W		Horizontal Datum: <input type="checkbox"/> NAD 1927 <input checked="" type="checkbox"/> NAD 1983
A6. Attach at least 2 photographs of the building if the Certificate is being used to obtain flood insurance.		
A7. Building Diagram Number <u>7</u>		
A8. For a building with a crawlspace or enclosure(s):		
a) Square footage of crawlspace or enclosure(s)		<u>1850.00</u> sq ft
b) Number of permanent flood openings in the crawlspace or enclosure(s) within 1.0 foot above adjacent grade		<u>N/A</u>
c) Total net area of flood openings in A8.b		<u>N/A</u> sq in
d) Engineered flood openings? <input type="checkbox"/> Yes <input checked="" type="checkbox"/> No		
A9. For a building with an attached garage:		
a) Square footage of attached garage		<u>600.00</u> sq ft
b) Number of permanent flood openings in the attached garage within 1.0 foot above adjacent grade		<u>                    </u>
c) Total net area of flood openings in A9.b		<u>N/A</u> sq in
d) Engineered flood openings? <input type="checkbox"/> Yes <input checked="" type="checkbox"/> No		

SECTION B - FLOOD INSURANCE RATE MAP (FIRM) INFORMATION					
B1. NFIP Community Name & Community Number Fayette County 130432		B2. County Name Fayette		B3. State Georgia	
B4. Map/Panel Number 13113C0092E	B5. Suffix E	B6. FIRM Index Date 09-26-2008	B7. FIRM Panel Effective/ Revised Date 09-26-2008	B8. Flood Zone(s) X (unshaded)	B9. Base Flood Elevation(s) (Zone AO, use Base Flood Depth) 849.18 (lake)
B10. Indicate the source of the Base Flood Elevation (BFE) data or base flood depth entered in Item B9: <input type="checkbox"/> FIS Profile <input type="checkbox"/> FIRM <input type="checkbox"/> Community Determined <input checked="" type="checkbox"/> Other/Source: <u>County Flood Hazard Certificate (see attached)</u>					
B11. Indicate elevation datum used for BFE in Item B9: <input type="checkbox"/> NGVD 1929 <input checked="" type="checkbox"/> NAVD 1988 <input type="checkbox"/> Other/Source: <u>                    </u>					
B12. Is the building located in a Coastal Barrier Resources System (CBRS) area or Otherwise Protected Area (OPA)? <input type="checkbox"/> Yes <input checked="" type="checkbox"/> No Designation Date: <u>                    </u> <input type="checkbox"/> CBRS <input type="checkbox"/> OPA					

# ELEVATION CERTIFICATE

OMB No. 1660-0008  
Expiration Date: November 30, 2022

<b>IMPORTANT: In these spaces, copy the corresponding information from Section A.</b>			<b>FOR INSURANCE COMPANY USE</b>
Building Street Address (including Apt., Unit, Suite, and/or Bldg. No.) or P.O. Route and Box No. 190 Dockside Drive Tax Parcel 070337004			Policy Number:
City Fayetteville	State Georgia	ZIP Code 30215	Company NAIC Number

## SECTION C – BUILDING ELEVATION INFORMATION (SURVEY REQUIRED)

C1. Building elevations are based on:  Construction Drawings\*  Building Under Construction\*  Finished Construction  
 \*A new Elevation Certificate will be required when construction of the building is complete.

C2. Elevations – Zones A1–A30, AE, AH, A (with BFE), VE, V1–V30, V (with BFE), AR, AR/A, AR/AE, AR/A1–A30, AR/AH, AR/AO.  
 Complete Items C2.a–h below according to the building diagram specified in Item A7. In Puerto Rico only, enter meters.  
 Benchmark Utilized: Sub BM (Crescent Creek Dr.) Vertical Datum: NAVD 1988

Indicate elevation datum used for the elevations in items a) through h) below.  
 NGVD 1929  NAVD 1988  Other/Source: \_\_\_\_\_



Datum used for building elevations must be the same as that used for the BFE.

		Check the measurement used.
a) Top of bottom floor (including basement, crawlspace, or enclosure floor)	<u>880.4</u>	<input checked="" type="checkbox"/> feet <input type="checkbox"/> meters
b) Top of the next higher floor	<u>890.7</u>	<input checked="" type="checkbox"/> feet <input type="checkbox"/> meters
c) Bottom of the lowest horizontal structural member (V Zones only)	<u>N/A</u>	<input checked="" type="checkbox"/> feet <input type="checkbox"/> meters
d) Attached garage (top of slab)	<u>889.0</u>	<input checked="" type="checkbox"/> feet <input type="checkbox"/> meters
e) Lowest elevation of machinery or equipment servicing the building (Describe type of equipment and location in Comments)	<u>885.4</u>	<input checked="" type="checkbox"/> feet <input type="checkbox"/> meters
f) Lowest adjacent (finished) grade next to building (LAG)	<u>879.7</u>	<input checked="" type="checkbox"/> feet <input type="checkbox"/> meters
g) Highest adjacent (finished) grade next to building (HAG)	<u>888.9</u>	<input checked="" type="checkbox"/> feet <input type="checkbox"/> meters
h) Lowest adjacent grade at lowest elevation of deck or stairs, including structural support	<u>880.0</u>	<input checked="" type="checkbox"/> feet <input type="checkbox"/> meters

## SECTION D – SURVEYOR, ENGINEER, OR ARCHITECT CERTIFICATION

This certification is to be signed and sealed by a land surveyor, engineer, or architect authorized by law to certify elevation information. I certify that the information on this Certificate represents my best efforts to interpret the data available. I understand that any false statement may be punishable by fine or imprisonment under 18 U.S. Code, Section 1001.

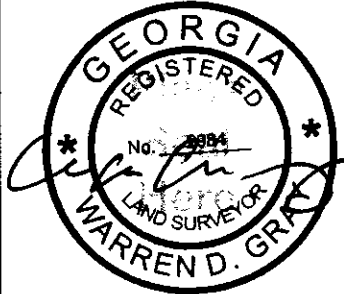
Were latitude and longitude in Section A provided by a licensed land surveyor?  Yes  No  Check here if attachments.

Certifier's Name Warren Gray	License Number 2984		
Title Georgia Registered Land Surveyor			
Company Name W. D. Gray and Associates, Inc.			
Address 160-B Greencastle Road			
City Tyrone	State Georgia		ZIP Code 30290
Signature 	Date 06-21-2022	Telephone (770) 486-7552	Ext.

Copy all pages of this Elevation Certificate and all attachments for (1) community official, (2) insurance agent/company, and (3) building owner.

Comments (including type of equipment and location, per C2(e), if applicable)  
 Per the referenced flood insurance rate map, a portion of this lot is in a Zone A (no base flood elevation determined) flood hazard area and a portion is in a Zone "X" unshaded designated area. Per the attached Flood Hazard Certificate (see attached) issued by the Fayette County Environmental Management Dept., the LAKE Base Flood Elevation at this lot is 849.18. W. D. Gray and Associates, Inc. did not participate in establishing this Base Flood Elevation. The machinery in section "C" (C2e) is an outside HVAC unit. Sq. Ft. in section "A" are approximate. The Latitude and Longitude was determined using google earth. For a better understanding of flooding, flood risk and available flood insurance programs please visit [www.fema.gov](http://www.fema.gov).

# ELEVATION CERTIFICATE

OMB No. 1660-0008  
Expiration Date: November 30, 2022

<b>IMPORTANT: In these spaces, copy the corresponding information from Section A.</b>			<b>FOR INSURANCE COMPANY USE</b>
Building Street Address (including Apt., Unit, Suite, and/or Bldg. No.) or P.O. Route and Box No. 190 Dockside Drive Tax Parcel 070337004			Policy Number:
City Fayetteville	State Georgia	ZIP Code 30215	Company NAIC Number

## SECTION E – BUILDING ELEVATION INFORMATION (SURVEY NOT REQUIRED) FOR ZONE AO AND ZONE A (WITHOUT BFE)

For Zones AO and A (without BFE), complete Items E1–E5. If the Certificate is intended to support a LOMA or LOMR-F request, complete Sections A, B, and C. For Items E1–E4, use natural grade, if available. Check the measurement used. In Puerto Rico only, enter meters.

- E1. Provide elevation information for the following and check the appropriate boxes to show whether the elevation is above or below the highest adjacent grade (HAG) and the lowest adjacent grade (LAG).
- a) Top of bottom floor (including basement, crawlspace, or enclosure) is \_\_\_\_\_  feet  meters  above or  below the HAG.
- b) Top of bottom floor (including basement, crawlspace, or enclosure) is \_\_\_\_\_  feet  meters  above or  below the LAG.
- E2. For Building Diagrams 6–9 with permanent flood openings provided in Section A Items 8 and/or 9 (see pages 1–2 of Instructions), the next higher floor (elevation C2.b in the diagrams) of the building is \_\_\_\_\_  feet  meters  above or  below the HAG.
- E3. Attached garage (top of slab) is \_\_\_\_\_  feet  meters  above or  below the HAG.
- E4. Top of platform of machinery and/or equipment servicing the building is \_\_\_\_\_  feet  meters  above or  below the HAG.
- E5. Zone AO only: If no flood depth number is available, is the top of the bottom floor elevated in accordance with the community's floodplain management ordinance?  Yes  No  Unknown. The local official must certify this information in Section G.

## SECTION F – PROPERTY OWNER (OR OWNER'S REPRESENTATIVE) CERTIFICATION

The property owner or owner's authorized representative who completes Sections A, B, and E for Zone A (without a FEMA-issued or community-issued BFE) or Zone AO must sign here. The statements in Sections A, B, and E are correct to the best of my knowledge.

Property Owner or Owner's Authorized Representative's Name

Address \_\_\_\_\_ City \_\_\_\_\_ State \_\_\_\_\_ ZIP Code \_\_\_\_\_

Signature \_\_\_\_\_ Date \_\_\_\_\_ Telephone \_\_\_\_\_

Comments

Check here if attachments.



# ELEVATION CERTIFICATE

## BUILDING PHOTOGRAPHS

See Instructions for Item A6.

OMB No. 1660-0008  
Expiration Date: November 30, 2022

<b>IMPORTANT: In these spaces, copy the corresponding information from Section A.</b>			<b>FOR INSURANCE COMPANY USE</b>
Building Street Address (including Apt., Unit, Suite, and/or Bldg. No.) or P.O. Route and Box No. 190 Dockside Drive Tax Parcel 070337004			Policy Number:
City Fayetteville	State Georgia	ZIP Code 30215	Company NAIC Number

If using the Elevation Certificate to obtain NFIP flood insurance, affix at least 2 building photographs below according to the instructions for Item A6. Identify all photographs with date taken; "Front View" and "Rear View"; and, if required, "Right Side View" and "Left Side View." When applicable, photographs must show the foundation with representative examples of the flood openings or vents, as indicated in Section A8. If submitting more photographs than will fit on this page, use the Continuation Page.



Photo One

Photo One Caption Front 06 /14 /2022

Clear Photo One

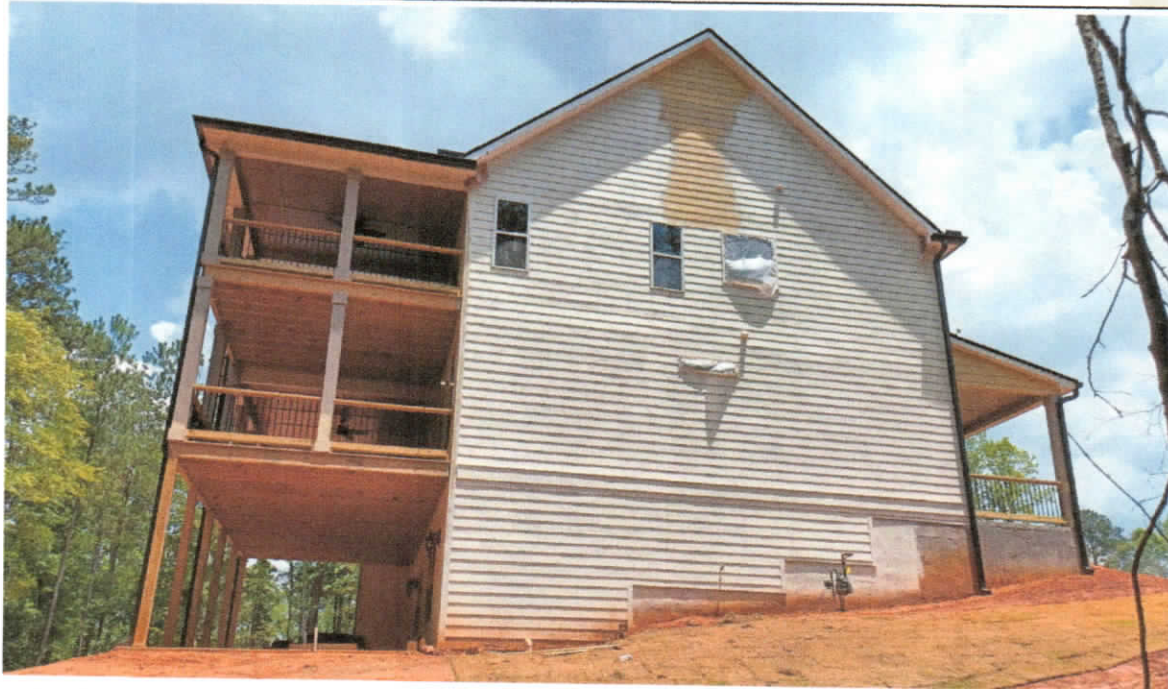

Photo Two

Photo Two Caption Left 06 /14 / 2022

Clear Photo Two



# BUILDING PHOTOGRAPHS

## ELEVATION CERTIFICATE

Continuation Page

OMB No. 1660-0008

Expiration Date: November 30, 2022

<b>IMPORTANT: In these spaces, copy the corresponding information from Section A.</b>			<b>FOR INSURANCE COMPANY USE</b>
Building Street Address (including Apt., Unit, Suite, and/or Bldg. No.) or P.O. Route and Box No. 190 Dockside Drive Tax Parcel 070337004			Policy Number:
City Fayetteville	State Georgia	ZIP Code 30215	Company NAIC Number

If submitting more photographs than will fit on the preceding page, affix the additional photographs below. Identify all photographs with: date taken; "Front View" and "Rear View"; and, if required, "Right Side View" and "Left Side View." When applicable, photographs must show the foundation with representative examples of the flood openings or vents, as indicated in Section A8.



Photo Three

Photo Three Caption Right 06 /14/ 2022

Clear Photo Three



Photo Four

Photo Four Caption Rear 06 /14 / 2022

Clear Photo Four

# ATTACHMENT TO F.E.C.



*Fayette*  
COUNTY

Environmental  
Management  
Department

## Flood Hazard Certificate

Permit No.: FHAZ-04-2021-064576

Parcel No: 070337004

Permit Status: Issued

**Permit Note :**

140 Stonewall Avenue West Suite 203  
Fayetteville, GA 30214  
Phone: (770) 305-5410

**Permit Issued Date: 4/22/2021**

<b>Subdivision:</b>	Canoe Club at Waterlace Pod F	<b>Lot #:</b>	386
<b>Address:</b>	190 DOCKSIDE DR, LT, Fayetteville, GA 30215	<b>100 Yr. Flood Plain Elevation</b>	849.18
<b>FIRM Panel #:</b>	13113C0092E	<b>Date:</b>	9/26/2008
<b>Creek Name:</b>	Pelham Creek	<b>Watercourse Type:</b>	Lake
<b>Total Acreage:</b>	1.47	<b>Disturbed Acreage:</b>	0.5
<b>Owner:</b>	New LeafNLH	<b>Phone Number:</b>	6786181478
<b>Builder:</b>	New LeafNLH	<b>Phone Number:</b>	6786181478
<b>Natural Buffer:</b>	100'	<b>Impervious Setback:</b>	75'
<b>Base Flood Elevation</b>	849.18	<b>MFFE:</b>	852.18

NOTE: SEE ATTACHED PLAT FOR EXACT STRUCTURE(S) LOCATION AND SETBACKS. PROPERTY CORNERS MUST BE ADEQUATELY STAKED.

### APPLICANT'S COVENANT

As the applicant for a Certification of Stormwater Compliance for the property hereon described, I do hereby covenant that the information supplied with this application is true and correct and I do hereby agree to comply with the ordinances of Fayette County pertaining to floodplain, watershed protection, and erosion & sediment control. It is understood and agreed by the applicant that any error, misstatement, or misrepresentation of fact, either with or without intention on his part, such as might if known, cause a refusal of this application or any alteration or change in plans made without approval of the Stormwater Compliance, shall constitute sufficient grounds for revocation of said Certificate of Stormwater and any Building Permit resulting therefrom.

APPLICANT

DATE

\_\_\_\_\_