

November 21, 2019

**Subject: ITB #1751-B: Veterans Parkway at SR92 – Signalization
Addendum #1**

Gentlemen/Ladies:

Below, please find responses to questions, clarification, or additional information for the above referenced Invitation to Bid. You will need to consider this information when preparing your bid.

- 1. Five sheets from the bid plans (stamped with revision date of 11/21/19) and the Pricing Sheet have been updated. The revised documents correct quantity discrepancies between the plans and pricing Sheet. There is no change in overall project scope.**
- 2. Change to General Note 6 on Sheet 04-01. Unsuitable and waste material will not be allowed to be buried in the right-of-way (County or State). The revised note reads:**

It shall be the Contractor's responsibility to furnish suitable borrow material for the project and to dispose of any unsuitable or waste material in compliance with local, state, and federal regulations. Concrete and asphalt materials removed from the project site may not be placed in fill areas (or any other area) within easements or the project right-of-way.
- 3. Fayette County is providing the concrete strain poles and much of the traffic signal equipment. See plans and specifications for details. This is not a change from the original ITB.**
- 4. Reflective Pavement Markers are required, as shown on the Signing and Marking Plans.**
- 5. The Bid Opening Date remains 3:00 PM, Tuesday, November 26, 2019.**

Received by (Name): _____ Company _____

Note: If this addendum is not returned to the Fayette County Purchasing Department or if it is returned not signed, responding individuals, companies or other organizations will still be responsible for the requirements of this addendum and the specifications or changes herein.

The opening date for this ITB has not changed. **The opening time and date are 3pm, Tuesday, November 26, 2019.** Bids must be received by the Purchasing Department at the address above, Suite 204, at or before the opening date and time.

The deadline for inquiries has passed, so the Purchasing Department will not be able to accept any additional questions after this time.

If you have questions, please contact Natasha Duggan, Contract Administrator at (770) 305-5150 fax (770) 719-5534 or email at nduggan@fayettecountyga.gov.

Sincerely,

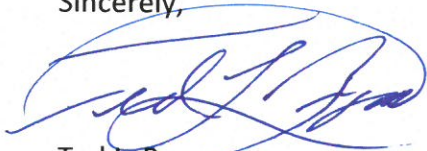

Ted L. Burgess
Director of Purchasing

Pricing Sheet						
Invitation to Bid #1751-B: Veterans Parkway at SR92 - Signalization						
Project Name: Veterans Pkwy and Westbridge Rd @ SR 92						
Project No: RS-F / 1886.019 ITB #1751-B						
No.	Item No.	Description	Estimated Quantity	Units	Unit Price	Extended Cost
1	150-1000	TRAFFIC CONTROL -	1	LS		
2	163-0232	TEMPORARY GRASSING	1	AC		
3	163-0240	MULCH	2	TN		
4	163-0528	CONSTRUCT AND REMOVE FABRIC CHECK DAM - TP C SILT FENCE	187	LF		
5	163-0550	CONSTRUCT AND REMOVE INLET SEDIMENT TRAP	1	EA		
6	165-0010	MAINTENANCE OF TEMPORARY SILT FENCE, TP A	2789	LF		
7	165-0041	MAINTENANCE OF CHECK DAMS - ALL TYPES	187	LF		
8	165-0105	MAINTENANCE OF INLET SEDIMENT TRAP	1	EA		
9	171-0010	TEMPORARY SILT FENCE, TYPE A	2789	LF		
10	210-0100	GRADING COMPLETE -	1	LS		
11	310-1101	GR AGGR BASE CRS, INCL MATL	1436	TN		
12	318-3000	AGGR SURF CRS	10	TN		
13	402-1802	RECYCLED ASPH CONC PATCHING, INCL BITUM MATL & H LIME	10	TN		
14	402-3121	RECYCLED ASPH CONC 25 MM SUPERPAVE, GP 1 OR 2, INCL BITUM MATL & H LIME	477	TN		
15	402-3130	RECYCLED ASPH CONC 12.5 MM SUPERPAVE, GP 2 ONLY, INCL BITUM MATL & H LIME	547	TN		
16	402-3190	RECYCLED ASPH CONC 19 MM SUPERPAVE, GP 1 OR 2, INCL BITUM MATL & H LIME	239	TN		
17	413-0750	TACK COAT	1949	GL		
18	432-5010	MILL ASPH CONC PVMT, VARIABLE DEPTH	3987	SY		
19	441-0754	CONCRETE MEDIAN, 7 1/2 IN	61	SY		
20	441-7011	CURB CUT WHEELCHAIR RAMP, TP A	1	EA		
21	441-7012	CURB CUT WHEELCHAIR RAMP, TP B	3	EA		
22	446-1100	PVMT REINF FABRIC STRIPS, TP 2, 18 INCH WIDTH	2848	LF		
23	500-9999	CLASS B CONC, BASE OR PVMT WIDENING	61	CY		
24	550-1180	STORM DRAIN PIPE, 18 IN, H 1-10	10	LF		
25	603-2181	STN DUMPED RIP RAP, TP 3, 18 IN	26	SY		
26	611-8050	ADJUST MANHOLE TO GRADE	3	EA		
27	636-1020	HIGHWAY SIGNS, TP 1 MATL, REFL SHEETING, TP 3	70	SF		
28	636-1033	HIGHWAY SIGNS, TP 1 MATL, REFL SHEETING, TP 9	33	SF		
29	636-1041	HIGHWAY SIGNS, TP 2 MATL, REFL SHEETING, TP 9	62	SF		
30	636-2070	GALV STEEL POSTS, TP 7	188	LF		
31	641-5001	GUARDRAIL ANCHORAGE, TP 1	1	EA		
32	641-1200	GUARDRAIL, TP W	198	LF		
33	641-5015	GUARDRAIL TERMINAL, TP 12A, 31 IN, TANGENT, ENERGY-ABSORBING	1	EA		
34	647-1000	TRAFFIC SIGNAL INSTALLATION NO -1, COMPLETE	1	LS		
35	647-2141	PULL BOX, PB-4S	1	EA		
36	653-0120	THERMOPLASTIC PVMT MARKING, ARROW, TP 2	14	EA		
37	653-0130	THERMOPLASTIC PVMT MARKING, ARROW, TP 3	6	EA		
38	653-1501	THERMOPLASTIC SOLID TRAF STRIPE, 5 IN, WHITE	3526	LF		
39	653-1502	THERMOPLASTIC SOLID TRAF STRIPE, 5 IN, YELLOW	1441	LF		
40	653-1704	THERMOPLASTIC SOLID TRAF STRIPE, 24 IN, WHITE	92	LF		
41	653-1804	THERMOPLASTIC SOLID TRAF STRIPE, 8 IN, WHITE	1397	LF		
42	653-3501	THERMOPLASTIC SKIP TRAF STRIPE, 5 IN, WHITE	381	GLF		
43	653-6004	THERMOPLASTIC TRAF STRIPING, WHITE	569	SY		
44	653-6006	THERMOPLASTIC TRAF STRIPING, YELLOW	374	SY		
45	654-1001	RAISED PVMT MARKERS TP 1	38	EA		
46	654-1003	RAISED PVMT MARKERS TP 3	54	EA		
47	656-5000	REMOVE EXIST TRAF MARKINGS -	17	EA		
48	660-3550	ROCK EXCAVATION - ADDITIONAL SERVICES	10	CY		
49	682-9950	DIRECTIONAL BORE -3 IN	1621	LF		
50	682-9950	DIRECTIONAL BORE -5 IN	191	LF		
51	700-6910	PERMANENT GRASSING	2	AC		
52		ALLOWANCE	1	LS	\$ 50,000.00	\$50,000.00
Grand Total Base Bid					s	



FAYETTE COUNTY BOARD OF COMMISSIONERS

VETERANS PARKWAY AT SR 92

LAND LOT 256 OF THE 13TH DISTRICT,
 FAYETTE COUNTY, GEORGIA
 PROJECT PHASE: SIGNALIZATION
 FAYETTE COUNTY 2004 SPLOST PROJECT ID: R-5F
 PROJECT NO. 1866.019

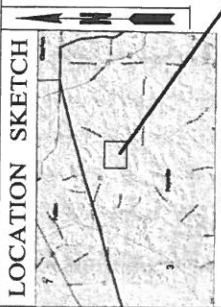

NOT TO SCALE
 NOTE: THE COORDINATES LISTED ARE WEST ZONE GRID COORDINATES LISTED IN THE STATE PLANE COORDINATE SYSTEM OF 1983
 HORIZONTAL DATUM : NAD 1983 MARN
 VERTICAL DATUM : NAVD 1988
 PROJECT UNITS: ENGLISH

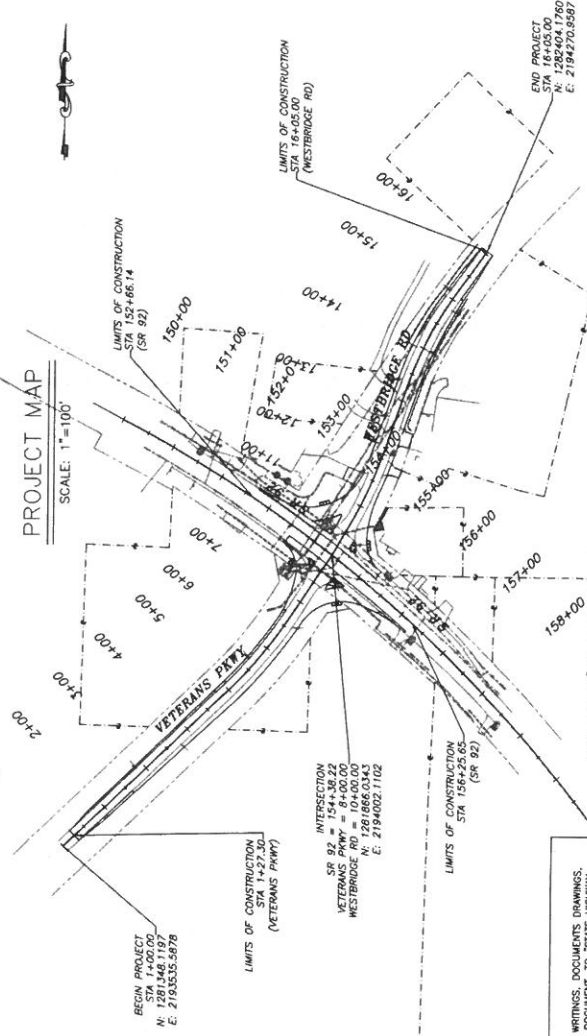

NOTE: THE DATA TOGETHER WITH ALL OTHER INFORMATION SHOWN ON THESE PLANS, OR IN ANY WAY THE DATA, TOGETHER WITH ALL OTHER INFORMATION SHOWN ON THESE PLANS, OR IN ANY WAY FIELD INVESTIGATIONS AND ARE BELIEVED TO BE CORRECT. THE DATA IS NOT GUARANTEED. THE SAME ARE SHOWN AS INFORMATION ONLY, ARE NOT GUARANTEED, AND DO NOT BIND THE FAYETTE COUNTY, FOR THE CONSTRUCTION OF ROADS AND BRIDGES, CURRENT EDITION, AND ANY MODIFICATIONS THEREOF, WHICH WILL BE A PART OF THIS CONTRACT.

ALL WORK TO BE DONE IN ACCORDANCE WITH THE SPECIFICATIONS OF THE DEPARTMENT OF TRANSPORTATION, AND AS MODIFIED BY CONTRACT DOCUMENTS.

LENGTH OF PROJECT	COUNTY NO
NET LENGTH OF ROADWAY	113
NET LENGTH OF BRIDGES	0.29
NET LENGTH OF PROJECT	0.00
NET LENGTH OF EXCEPTIONS	0.29
GROSS LENGTH OF PROJECT	0.29

THIS PROJECT IS LOCATED 100% IN FAYETTE COUNTY
 THIS PROJECT IS LOCATED 100% IN CONGRESSIONAL DISTRICT NO.13
 THIS PROJECT IS LOCATED 100% IN LAND DISTRICT 13

PROJECT DESIGNATION: SIGNALIZATION
 PDP CLASSIFICATION: N/A
 FUNCTIONAL CLASSIFICATION: MINOR ARTERIAL
 FEDERAL ROUTE NO. N/A
 STATE ROUTE NO. 92

PROJECT MIDPOINT
 STA. 7+63.31
 N 1281825.7698
 E 2193996.5795



PREPARED BY: DESIGN
 UNDER THE SUPERVISION OF: CHRIS RIDEOUTI, P.E.
 DESIGN



REVISIONS	DATE	SHEET NO.	REQUESTED BY	GSWCC NO.	SIGNATURE
	11/29/2019	1-01, 3-01, 6-01, 6-02, 27-02			

PLANS COMPLETED: 10/04/2019

ROADWAY ITEMS

LOCATION	GR AGR BASE CRS. 6 INCH. INCL MATT.	GR AGR BASE CRS. 10 INCH. INCL MATT.	AGR SURFACE CRS*	RECYCLED ASPH CONC PATCHING	RECYCLED ASPH CONC 25 MM SUPERPAVE. GP 1 OR 2. INCL BITUM.	RECYCLED ASPH CONC 19 MM SUPERPAVE. GP 1 OR 2. INCL BITUM.	RECYCLED ASPH CONC 12.5 MM SUPERPAVE. GP 2 ONLY. INCL BITUM.	TACK COAT	MILL ASPHALT CONC. PMAT. VARIABLE DEPTH	CONCRETE MEDIAN, 7.5 IN.	CURB CUT WHEELCHAIR RAMP TP A	CURB CUT WHEELCHAIR RAMP TP B	PMT RINF FABRIC STRIPS, TP 2. 18 IN WDE	CLASS B CONC BASE OR PMT WIDENING
VETERANS PKWY	8	664	10	201	100	271	990	2121	30	1	1	1	1473	45
WESTBRIDGE RD DRIVEWAYS	8	756		276	139	256	935	1866	31	2	2		1375	16
TOTAL	16	1420	10	477	239	547	1949	3987	61	1	3		2848	61

GRADING COMPLETE
LUMP SUM

TRAFFIC CONTROL
LUMP SUM

GUARDRAIL QUANTITIES

LOCATION & SIDE	GUARDRAIL "W" BEAM	GUARDRAIL TERMINAL, TP 12A - 31" TANGENT, - ENERGY - ABSORBING	GUARDRAIL ANCHORAGE TP 1
STA. 12+55 - 15+17 RT	198	1	1
TOTAL	198	1	1

PERMANENT EROSION CONTROL

LOCATION	STD DUMPED RIP RAP TP 3, 18 IN.	PERMANENT GRASSING	TEMPORARY GRASSING
SUB-TOTAL	26	2	1
TOTAL	26	2	1

TEMPORARY EROSION CONTROL

LOCATION	MULCH- DISTURBED AREA	TEMPORARY SILT FENCE TP 5	TEMPORARY SILT FENCE TP 5	CONSTRUCT & REMOVE INLET SEDIMENT TRAP	MAINTENANCE OF INLET SEDIMENT TRAP	CONSTRUCT & REMOVE FABRIC CHECK DAM-TP C SILT FENCE	MAINTENANCE OF CHECK DAMS - ALL TYPES
SUB-TOTAL	2	2789	2789	1	1	187	187
TOTAL	2	2789	2789	1	1	187	187

DRAINAGE ITEMS

STRUCTURE NUMBER	LOCATION	18" STORM DRAIN PIPE, H 1-10	ADJUST MANHOLE TO GRADE	GDOT 9031U 18" PIPE COLLAR**
VETERANS PKWY		1		
WESTBRIDGE RD		2		
EX A4.1 10+77.71 RT				1
A4.2 10+83.20 RT		10		
PROJECT TOTALS		10	3	1

**NOTE:
PAYMENT OF
LIN. FT. OF
PIPE INCLUDES
COLLAR BASE
GA STD 9031U

*FOR USE IN INCLEMENT WEATHER TO FACILITATE THE MOVEMENT OF LOCAL TRAFFIC ALONG ROADWAY CONSTRUCTION AND TO PERMIT INGRESS & EGRESS AT DRIVES. WHEN USED FOR THIS PURPOSE, SECTION 318 OF GEORGIA STANDARD SPECIFICATIONS IS MODIFIED TO PERMIT TRUCK DUMPING ON UNPAVED AND MUDDY SUBGRADE.

THE CONTRACTOR WILL HAVE THE CHOICE OF THE FOLLOWING MATERIALS.
GRADED AGGREGATE - ART.815.01
COARSE AGGREGATE - SIZE - 467 - ART.800.01
STABILIZER AGGREGATE - TYPE 1 OR 2 - SECT.803
ALL MATERIALS TO BE USED AS DIRECTED BY THE ENGINEER.

REVISION DATES

DATE	DESCRIPTION
11/21/2019	

CROY
 200 NORTH COBB PARKWAY, SUITE 400, SUITE 413
 PHONE: (770) 971-5467 FAX: (770) 971-9820
 WEBSITE: WWW.CROYCORPORATION.COM
 CROY CORPORATION IS AN EQUAL OPPORTUNITY EMPLOYER AND CONTRACTOR.

FAYETTE COUNTY
 VETERANS PARKWAY AT SR 92
 SUMMARY OF QUANTITIES
 DRAWING NO. 06-01

LOCATION	STANDARD SIGNS													
	HIGHWAY SIGNS TP 1 MAIL REFL SHEETING TP 3		HIGHWAY SIGNS TP 1 MAIL REFL SHEETING TP 9		POSTS TYPE 7		POSTS TYPE 9		TOTAL					
	SIGN CODE	SIZE	QTY	SQ. FT	SIGN CODE	SIZE	QTY	SQ. FT	LENGTH (FT)	QTY	LENGTH (FT)	QTY	LENGTH (FT)	TOTAL LENGTH
VETERANS PKWY 01+59 RT					W3-3	30" X 30"	1	6.25	14	1	14			
					W16-9P	24" X 12"	1	2.00						
05+89 LT	R2-1	24" X 30"	1	5.00					14	1	14			
07+27 RT	R560-5	24" X 30"	1	5.00					14	1	14			
07+32 LT					R1-2	36" X 36" X 36"	1	3.9	13	1	13			
07+52 RT					R1-2	36" X 36" X 36"	1	3.9	13	1	13			
07+53 RT	R2-1	24" X 30"	1	5.00					14	1	14			
07+58 LT	R560-5	24" X 30"	1	5.00					14	1	14			
SPAN WIRE	R10-5A	30" X 36"	2	15.00					13	1	13			
WESTBRIDGE RD														
SPAN WIRE	R10-5A	30" X 36"	2	15.00					14	1	14			
10+40 LT	R2-1	24" X 30"	1	5.00					13	1	13			
10+41 RT	R560-5	24" X 30"	1	5.00					13	1	13			
10+46 LT					R1-2	36" X 36" X 36"	1	3.9	13	1	13			
10+71 RT					R1-2	36" X 36" X 36"	1	3.9	13	1	13			
10+75 LT	R560-5	24" X 30"	1	5.00					13	1	13			
11+58 RT	R2-1	24" X 30"	1	5.00					14	1	14			
15+89 LT					W3-3	30" X 30"	1	6.25	14	1	14			
					W16-9P	24" X 12"	1	2.00						
TOTALS				70				32.1			188			

***SEE SHEET 27-02 FOR SIGNAL QUANTITIES

TRAFFIC STRIPE			
DESCRIPTION	UNIT	QUANTITY	
5" SOLID WHITE	LINEAL FT.	1526	
5" SOLID YELLOW	LINEAL FT.	1441	
24" SOLID WHITE	LINEAL FT.	192	
8" SOLID WHITE	LINEAL FT.	1397	
5" SKIP WHITE (2 SEC, 6" GAP)	GR. LINEAL FT.	381	
HATCH WHITE	SQ. YD.	569	
HATCH YELLOW	SQ. YD.	374	

NOTE:
ALL ARROWS SHALL BE WHITE UNLESS OTHERWISE SPECIFIED. SEE PLANS FOR LOCATION.

ARROWS (EACH)	QUANTITY
REFLECTIVE-RAISED YELLOW TYPE 1	14
REFLECTIVE-RAISED CLEAR TYPE 2	6
REFLECTIVE-RAISED CLEAR/RED TYPE 3	17

RAISED PAVEMENT MARKERS (EACH)			
DESCRIPTION	REFLECTIVE-RAISED YELLOW TYPE 1	CLEAR TYPE 2	CLEAR/RED TYPE 3
VETERANS PKWY	12		14
WESTBRIDGE RD	14		26
SR 92			26
TOTAL	38	0	54

OVERHEAD SPAN WIRE SIGNS				
SIGN CODE	HIGHWAY SIGNS TP 2 MAIL REFL SHEETING TP 9		OVERHEAD SIGN SHEET MATERIAL	
	SIZE	UNIT QTY.	UNIT	QTY.
D3-1	18" X 42"	EA	2	SQ. FT. 10.5
D3-2	18" X 104"	EA	1	SQ. FT. 13
D3-3	18" X 100"	EA	1	SQ. FT. 12.5
D3-4	18" X 100"	EA	1	SQ. FT. 12.5
D3-5	18" X 104"	EA	1	SQ. FT. 13
TOTAL			6	61.5



200 NORTH COBB PARKWAY, SUITE 400, SUITE 413
 PHONE: (770) 971-8407 FAX: (770) 971-0820
 WE STRIVE FOR EXCELLENCE IN SERVICE AND CUSTOMER SATISFACTION.

332 CABINET INPUT ASSIGNMENT

307	1	2	3	4	5	6	7	8	9	10	11	12	13	14
-----	---	---	---	---	---	---	---	---	---	----	----	----	----	----

UPPER INPUT FILE

TYPE	DET	DET	DET	DET	DET	DET	DET	DET	DET	DET	DET	DET	DET	DET	DET
CHANEL 1	56	43	76	47	58	45	78	49	62	53	69	70	82		
CI PIN	56	43	76	47	58	45	78	49	62	53	69	70	82		
FUNCTION	56	43	76	47	58	45	78	49	62	53	69	70	82		
FIELD TIME	10.12	10.55	10.91	10.12	10.56	10.92	11.12	10.56	10.92	11.12	10.56	10.92	11.12		

LOWER INPUT FILE

TYPE	DET	DET	DET	DET	DET	DET	DET	DET	DET	DET	DET	DET	DET	DET	DET
CHANEL 2	56	43	76	47	58	45	78	49	62	53	69	70	82		
CI PIN	56	43	76	47	58	45	78	49	62	53	69	70	82		
FUNCTION	56	43	76	47	58	45	78	49	62	53	69	70	82		
FIELD TIME	10.12	10.55	10.91	10.12	10.56	10.92	11.12	10.56	10.92	11.12	10.56	10.92	11.12		

ITEM NO.	DESCRIPTION	UNITS	QUANTITY
639-2002	STEEL WIRE STRAND CABLE, 3/8 IN**	LIN FT	560
639-5000	PRESTRESSED CONC STRAIN POLE, TP IV, 50 FT**	EACH	3
647-1000	TRAFFIC SIGNAL INSTALLATION NO.1	LUMP	1
647-2141	PULLBOX PB-4S	EACH	1
647-6200	LOOP DETECTOR, 6 FT X 6 FT, BIPOLE**	EACH	4
647-6300	LOOP DETECTOR, 6 FT X 50 FT, QUADRUPOLE**	EACH	4
660-3550	ROCK EXCAVATION-ADDITIONAL SERVICES	CU YDS	10
662-6233	CONDUIT NON-METAL, TP3, 2 IN**	LIN FT	1649
662-9950	DIRECTIONAL BORE, DESC. 3 IN	LIN FT	1621
662-9950	DIRECTIONAL BORE, DESC. 5 IN	LIN FT	191

***NOTE: MATERIALS LISTED FOR SIGNAL INSTALLATION ARE FOR INFORMATIONAL PURPOSES ONLY. ALL ITEMS WITH ASTERISKS NEXT TO THE DESCRIPTION AND STRIKED OUT QUANTITIES ARE TO BE PROVIDED BY THE COUNTY AND SHOULD NOT BE INCLUDED IN THE BID FOR SIGNAL INSTALLATION. THE CONTRACTOR SHALL DETERMINE THE MATERIALS AND QUANTITIES REQUIRED FOR THE COMPLETE AND ACCEPTED INSTALLATION.

***NOTE: IT HAS BEEN REPORTED THAT THERE IS THE POTENTIAL THAT THERE IS ROCK IN THE AREA. THE CONTRACTOR SHALL INCLUDE LINE ITEM 660-3550 ADDITIONAL SERVICES FOR ROCK EXCAVATION CLAUSE IN BID PRICE AND ANY ADDITIONAL COST ASSOCIATED WITH ROCK REMOVAL.

LIST OF MATERIALS
 TRAFFIC SIGNAL INSTALLATION NO.1

MATERIALS	UNIT	QUANTITY
NON-NEMA CABINET, CONTROLLER ASSEMBLIES	EACH	1
A. CABINET ASSEMBLY, MODEL 332A W AUXILIARY OUTPUT FILE	EACH	12
B. SWITCH PACK	EACH	3
C. DC ISOLATOR	EACH	1
D. 2010 EQUIP CONFLICT MONITOR EXTENDED FEATURES	EACH	1
E. 2070 CONTROLLER W/ CURRENT GDOT OPERATING SOFTWARE	EACH	5
F. 2-CHANNEL LOOP DETECTOR	EACH	4
G. 332 CABINET BASE**	EACH	4
H. 332 CABINET WORKPADS**	EACH	4
LOOP / PED DETECTOR LEAD-IN WIRE	LIN FT	1649
A. 3 PAIR, 18 AWG**		
SIGNAL CABLE	LIN FT	2299
B. 7-CONDUCTOR, (14 AWG)**		
ONE-WAY, 3-SECTION, 12" LED, TRAFFIC SIGNAL HEAD, PLASTIC**	EACH	44
ONE-WAY, 4-SECTION, 12" LED, TRAFFIC SIGNAL HEAD, PLASTIC**	EACH	4
BACK PLATE FOR ONE-WAY, 3-SECTION, 12" SIGNAL HEAD, 2" RETROREFLECTIVE TP**	EACH	44
BACK PLATE FOR ONE-WAY, 4-SECTION, 12" SIGNAL HEAD, 2" RETROREFLECTIVE TP**	EACH	4
ONE-WAY SECTION, 18" LED COUNTDOWN PEDESTRIAN SIGNAL HEAD, FULL HANDMAN PHELA-4, 9" HIGH NUMBERS & 12" SYMBOLS**	EACH	8
PEDESTRIAN PUSH BUTTON STATION ASSEMBLY	EACH	4
A. 9'X15', W/ DOUBLE PUSH BUTTON STATION ADAPTER FOR 4" DIA PEDESTRIAN POLE, ADJUSTABLE W/ ADAPTERS TO EXTEND FOR 9'X15' SIGNS**		
PEDESTRIAN SIGN	EACH	8
A. 9'X15', RIO-3E, (L)EFT OR (R)IGHT, STANDARD**		
PEDESTAL POLE, 10 FT. BASE AND FOOTING**	EACH	4
HARDWARE FOR SPAN WIRE MOUNTING (3 OR 4 SECTION SIGNAL HEADS AND SIGNS)**	EACH	28
HARDWARE FOR POST TOP ERECTION FOR 18" PEDESTRIAN SIGNAL HEADS, TWO-WAY MOUNTING**	EACH	4
PULLBOX, TYPE 2, POLYMER CONCRETE**	EACH	4
PULLBOX, TYPE 3, POLYMER CONCRETE**	EACH	4
CONDUIT NON-METAL, 1****	LIN FT	1649
CONDUIT NON-METAL, 2"	LIN FT	200
CONDUIT NON-METAL, 3"	LIN FT	60
OVERHEAD SPAN WIRE SIGNS	EACH	3
A. D3-1 #1 (SR32)		
B. D3-1 #2 (ARROW) VETERANS PKWY		
C. D3-1 #3 (WESTBRIDGE RD (ARROW))		
D. D3-1 #4 (ARROW) WESTBRIDGE RD		
E. D3-1 #5 (VETERANS PKWY (ARROW))		
F. RIO-5A (LEFT TURN YIELD ON FLASHING YELLOW ARROW SIGN)**		
MISC. MATL. TO COMPLETE INSTALLATION NO.1	LUMP	1

***NOTE: MATERIALS LISTED FOR SIGNAL INSTALLATION ARE FOR INFORMATIONAL PURPOSES ONLY. ALL ITEMS WITH ASTERISKS NEXT TO THE DESCRIPTION AND STRIKED OUT QUANTITIES ARE TO BE PROVIDED BY THE COUNTY AND SHOULD NOT BE INCLUDED IN THE BID FOR SIGNAL INSTALLATION. THE CONTRACTOR SHALL DETERMINE THE MATERIALS AND QUANTITIES REQUIRED FOR THE COMPLETE AND ACCEPTED INSTALLATION.



200 NORTH COBB PARKWAY, SUITE 413
 KENNESAW, GA 30144
 PHONE: (770) 971-8407 FAX: (770) 971-0820

REVISION DATES
 11/27/2019

FAYETTE COUNTY
 VETERANS PARKWAY AT SR 92
 SIGNAL OPERATIONS -
 VETERANS & WESTBRIDGE @
 SR 92
 DRAWING NO
 27-02