

MARK	SIZE	TYPE	MAT'L	FINISH	DEVICE	FRAME	THOLD	REMARKS
10	FR 2/8 X 6/8 X 1 1/2	A	FG/GL	PAINTED	KEY LOCK	HM	ALUM	
11	FR 3/0 X 6/8 X 1 1/2	B	UD/GL	STAIN	PASSAGE	WOOD	-	SOLID CORE
12	NOT USED							
13	3/0 X 6/8 X 1 1/2	C	UD	STAIN	SET 1	WOOD	-	SOLID CORE
14	NOT USED							
15	3/0 X 6/8 X 1 1/2	E	UD	STAIN	KEY LOCK	WOOD	-	SOLID CORE
16	3/0 X 6/8 X 1 1/2	F	FG/GL	PAINTED	KEY LOCK	HM	ALUM	SOLID CORE

SET 1:  
FULL/PUSH, KICK PLATE, CLOSURE

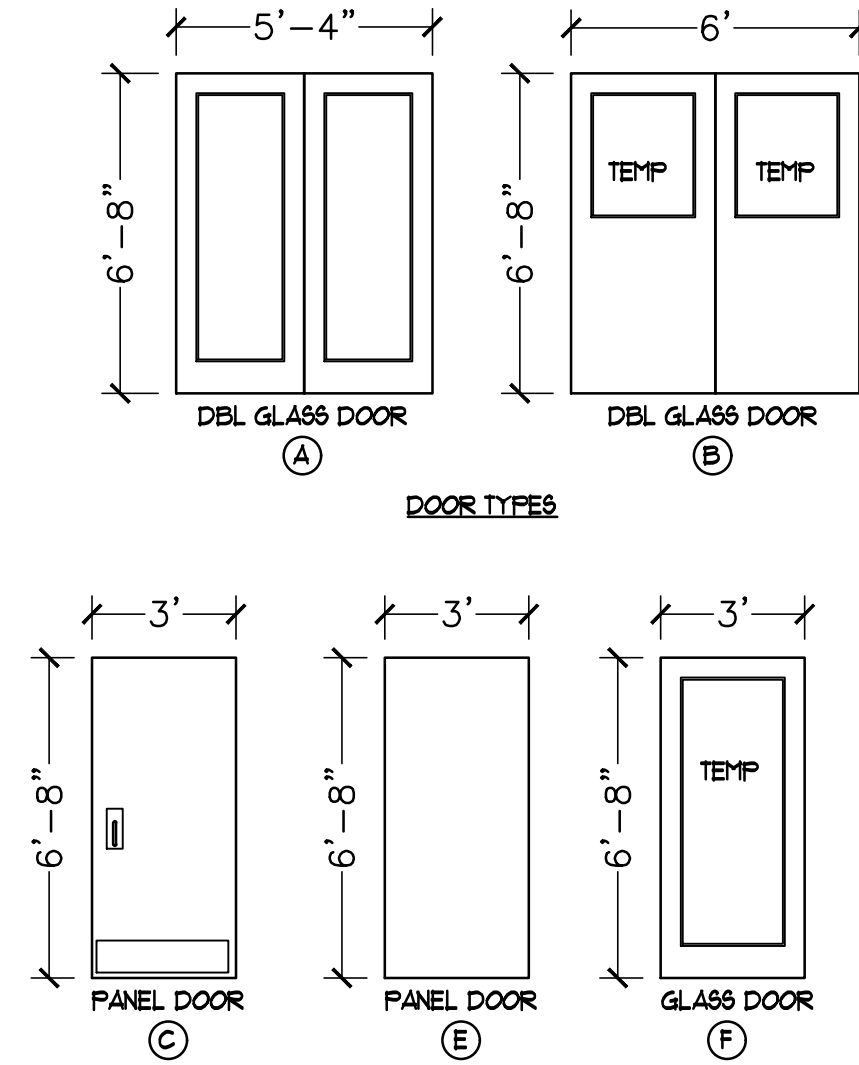

MARK	SIZE	TYPE	FRAME	GLASS HGT	REMARKS
A	8/8 X 1/6	FIXED GL-EXT	UD	6'-8 AFF	SITE VERIFY SIZE
B	3/0 X 3/0	FIXED GL-INT	UD	6'-8 AFF	TEMPERED

RM NO	NAME	FLOOR	BASE	WALLS	WAINSCOT	CEILING	REMARKS
101	NOT USED						
102	NOT USED						
103	MENS RESTRM	CER TILE	CER	PAINT	4' HIGH TILE	GYP/PAINT	PROVIDE TOILET PARTITIONS
104	WOMENS RESTRM	CER TILE	CER	PAINT	4' HIGH TILE	GYP/PAINT	PROVIDE TOILET PARTITIONS
105	STAGING RM/HALL	LUX VINYL	VINYL	PAINT	NONE	GYP/PAINT	
106	VIEWING HALL	LUX VINYL	VINYL	PAINT	NONE	GYP/PAINT	
107	DT TRAINING	LUX VINYL	VINYL	**	**	GYP/PAINT	
108	SHOOTING RM	LUX VINYL	VINYL	PAINT	NONE	GYP/PAINT	BLOCKING FOR EQUIPMENT
109	INSTRUC RESTRM	CER TILE	CER	PAINT	4' HIGH TILE	GYP/PAINT	
110	DRIVING RM	LUX VINYL	VINYL	PAINT	NONE	GYP/PAINT	BLOCKING FOR EQUIPMENT
111	STOR/CLASSRM	LUX VINYL	VINYL	PAINT	NONE	GYP/PAINT	

\*\* PROVIDE 48" PLYWOOD BACKING IN DT TRAINING ROOM WITH FRP OVER AND DRYWALL AND PAINT ABOVE TO CEILING

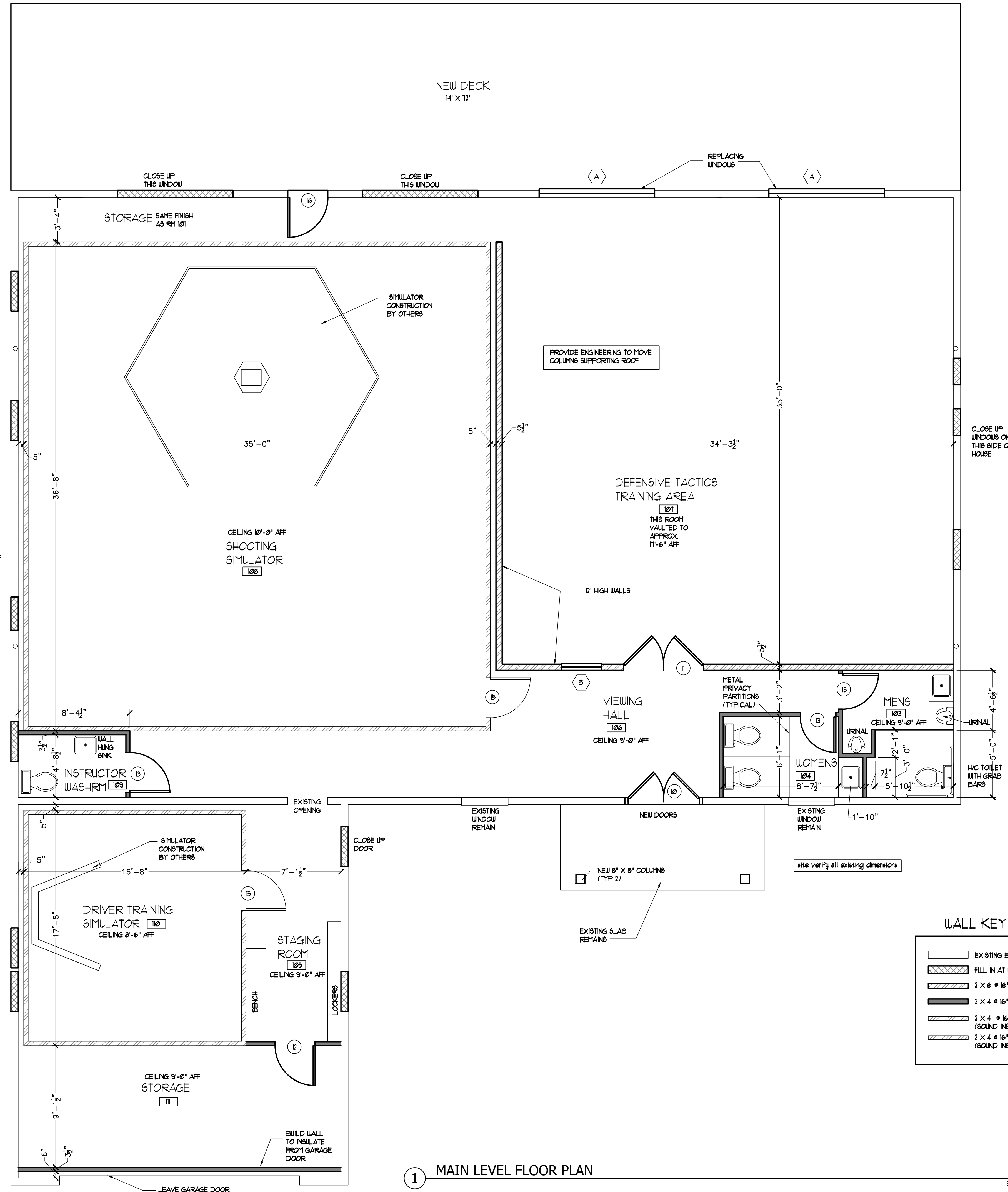

- NOTES:
- ALL UN-DIMENSIONED PARTITIONS ARE 3 1/2" ROUGH.
  - ALL ANGLED PARTITIONS ARE 45 DEGREES, UNLESS OTHERWISE NOTED.
  - PROVIDE MINIMUM 2-2x10's WITH 1/2" PLYWOOD FLITCH PLATE AT ALL EXTERIOR WALL OPENINGS AND INTERIOR BEARING WALL OPENINGS, UNLESS OTHERWISE NOTED.
  - 3-2x4's MINIMUM AT EACH END OF ALL BEAMS, UNLESS OTHERWISE NOTED. ALL SUCH CONCENTRATED LOADS SHALL BE TRANSFERRED TO FOUNDATION VIA BEAMS, POSTS, AND/OR SOLID BLOCKING.
  - ALL EXTERIOR DIMENSIONS ARE TO FACE OF STUDS, UNLESS OTHERWISE NOTED.
  - ALL ELECTRICAL AND MECHANICAL EQUIPMENT AND METERS ARE TO BE LOCATED PER FIELD CONDITIONS.
  - ALL GLASS LOCATED WITHIN 18" OF FLOOR, 12" OF A DOOR, OR LOCATED WITHIN 60" OF FLOOR AT BATHUBS, WHIRLPOOLS, SHOWERS, SAUNAS, STEAM ROOMS, OR HOT TUBS SHALL BE TEMPERED TO COMPLY WITH IRC SECTION R308.4.2.

[Symbol]	EXISTING EXTERIOR WALL TO REMAIN
[Symbol]	FILL IN AT WINDOWS THAT ARE REMOVED
[Symbol]	2 X 6 @ 16" OC WALLS BY 12' TALL
[Symbol]	2 X 4 @ 16" OC WALLS BY 9' TALL
[Symbol]	2 X 4 @ 16" OC WALLS BY 10'-0" TALL (SOUND INSUL)
[Symbol]	2 X 4 @ 16" OC WALLS BY 8'-6" TALL (SOUND INSUL)

MAIN LEVEL	3195 SF
GARAGE	722 SF
TOTAL HTD	3917 SF

DATE: 03-23-22  
 BID SET: 03-23-22  
 CHANGES PER OWNER: 03-23-22

RENOVATION FOR:  
**FAYETTE COUNTY SHERIFF'S DEPARTMENT**  
 2023 HEWELL ROAD  
 JONESBORO, GEORGIA

Master Home Designs, Inc.  
 678-568-4851

MASTER HOME DESIGNS, INC. ASSUMES NO LIABILITY FOR ANY WORK CONSTRUCTED FROM THESE PLANS UNLESS WE ARE SPECIFICALLY NOTIFIED IN WRITING. VERIFY ALL DIMENSIONS AND CONSTRUCTION TECHNIQUES PRIOR TO BEGINNING ANY WORK.

FLOOR PLAN

SHEET: **A3**

1 MAIN LEVEL FLOOR PLAN

Scale: 1/4"=1'-0"