

Meeting Minutes

May 5, 2020

2:00 P.M.

Committee Members Present: Randy Ognio, Fayette County BOC
Shayne Robinson, Peachtree City Citizen Representative
Charles W. Oddo, Fayette County BOC
Mayor Gary Laggis, Town of Woolsey
Jaimi Tapp, Town of Tyrone Citizen Representative
Maurice Ungaro, Town of Brooks Staff
Martin Sas, Fayette County Citizen Representative
Sgt. Chris Robison, Fayette County Sheriff's Office
Phil Mallon, Fayette County Staff

Committee Members Absent: Chris Hindman, City of Fayetteville Staff
Chelsie Boynton, Fayette County Staff

1. Call to Order by Chair Randy Ognio

Chairman Ognio called the May 5, 2020 Transportation Committee Meeting to order at 2:00 pm.

2. Ascertainment of Quorum

Chairman Ognio acknowledged that a Quorum of the Transportation Committee was present.

3. Acceptance of Meeting Agenda

Mrs. Robinson moved to accept the meeting agenda. Mayor Laggis seconded the motion. The motioned passed unanimously.

4. Review and Approval of the March Transportation Committee Meeting Minutes

Mrs. Robinson moved to accept the March meeting minutes. Mayor Laggis seconded the motion. The motioned passed unanimously. There was no April meeting due to the coronavirus pandemic.

5. Report of Committee Members

a. 2017 County SPLOST update

Mr. Mallon provided a three-page status table (see attached) of transportation SPLOST projects. The projects are grouped by the following types: bridge, intersection, new

capacity, maintenance, operations / safety, path and study. The table also shows the status of each phase of the project (concept, design, right-of-way, procurement, and construction) using a simple graphic. A filled-in circle indicates complete, a half circle indicates underway, and a circle outline indicates a phase about to begin. No symbol indicates no activity.

Mrs. Robinson said the Peachtree parkway at Crosstown Drive intersection in Peachtree City is on hold, but the City anticipates making some improvement at this location.

The Committee agreed that Fayette County should proceed with ICE analysis at SR 85 and Hwy 85C to determine if a signal is warranted (Project SR 85 south of Bernhard).

The Committee requested this report be updated quarterly. Mrs. Robinson asked that the table include completed projects.

b. **City/Town SPLOST updates** – There was no update on city/town projects.

6. **Public Comment** – None

7. **Unfinished Business** – None

8. **New Business**

a. **Hampton Road and SR 92 Intersection Project – Concept**

Mr. Mallon provided a project update to the Committee. Croy Engineering prepared an Intersection Control Evaluation (ICE) analysis from GDOT review and comment. The analysis recommends a RCUT control at the north Hampton Road intersection and a roundabout at the southern Hampton Road intersection. The concept is shown in the attached meeting notes (Alternate 4B). The latest and most substantial comment from GDOT (the District 3 office) was to remove the signal at the RCUT. The traffic volumes do not meet warrants.

The Committee noted that it appears to be the only viable improvement for these intersections. Mayor Laggis said the Town of Woolsey has several concerns about the roundabout (downstream drainage, noise, impacts to adjacent properties, etc.) but supports the project because of the anticipated safety and operational improvements, as well as being a physical means to reduce speed.

The Committee expressed concerns about the closing of the side frontage road, near the Antique Store. A suggestion was to make it one-way with a right-turn only onto Hampton Road. Phil will relay these concerns to the Engineer. The Committee also supported inclusion of a crosswalk across Hampton Road and inclusion of sidewalks between Town Hall and the Antique Store. Phil noted that details on grading, elevations and drainage are not available at the concept stage.

Action items for the project are for Fayette County and Croy to get ICE approval from GDOT. County staff will then present the approved concept to the Transportation Committee along with a draft community information package. The intent of the community engagement is to inform citizens on the project (who, what, where, when, why, etc.). The concept will require BOC approval prior to starting full design.

b. **Redwine Road, Bernhard Road and Peachtree Parkway Roundabout - Layout**

Mr. Mallon used the draft Signing and Marking Plans (see attachment) to give an update on the project's footprint and proposed path infrastructure. Mr. Robinson will provide a copy to Peachtree City. The project's right-of-way plans and construction plans are being finalized in May and June.

c. ARC TIP 2nd Quarter Update

Mr. Mallon reminded the Committee that federally funded projects in the planning, design or ROW phase are listed in the Atlanta Regional Commission's (ARC's) Transportation Improvement Program (TIP) and updated quarterly. A copy of the most recent TIP update (Fayette projects only) was provided (see attachment).

d. COVID-19 and Transportation

Mr. Mallon presented information from ARC's April 17, 2020 Transportation Coordinating Committee Meeting. He noted there is uncertainty on the short and long-term impacts of the COVID-19 pandemic on state and federal funding for transportation projects. ARC has not provided award recommendations for the TIP solicitation last fall (Fayette County submitted applications for: 1) SR 279 and Corinth Road alignment; 2) Resurfacing; and 3) Banks Road widening). The group discussed possible need to reprioritize County/City projects and possible new projects that could be submitted for consideration under a federal transportation stimulus package, if one were developed.

- 9. Adjournment** – The meeting adjourned at approximately 3:15 PM with a motion by Chairman Ognio and second by Shayne Robinson.











FAYETTE COUNTY TRANSPORTATION COMMITTEE

May 5, 2020



No.	Program	Category	Project Name	Concept	Design	ROW	Procure.	Utilities	Constr.
1	GDOT	Bridge	SR 85 @ Whitewater Creek Bridge Replacement	●	◐				
2	GDOT 2017 SPLOST	Bridge	Ebenezer Church @ Whitewater Creek Bridge Replacement (0008598)	●	◐	◐			
3	GDOT 2004 T-SPLOST	Bridge	Coastline Road Bridge Replacement (0015647)	◐					
4	2004 T-SPLOST	Bridge	EFB Bridge @ Morning Creek	◐					
5	GDOT	Intersection	SR 74 & I-85 Interchange (Fulton Co.)	●	◐	◐			
6	2017 SPLOST	Intersection	<i>Antioch/Hampton/Winn Way</i>	●	●	●	●	●	●
7	2017 SPLOST	Intersection	Redwine, Bernhard & Peachtree Pkwy Roundabout	●	◐	○			
8	2017 SPLOST	Intersection	Brogdon & New Hope Roundabout	●	◐	◐	○		
9	2017 SPLOST	Intersection	Ebenezer Church, Ebenezer & Spear	◐					
10	2004 SPLOST 2017 SPLOST	Intersection	<i>Antioch & Goza all-way stop</i>	●	●	●	●	●	●
11	2004 T-SPLOST Peachtree City	Intersection	Peachtree Parkway @ Crosstown Drive	◐					
12	2004 T-SPLOST	Intersection	Sandy Creek, Sams Drive & Eastin Rd Roundabout	○					
13	2004 T-SPLOST	Intersection	SR 85 (North of Bernhard)	○					

No.	Program	Category	Project Name	Concept	Design	ROW	Procure.	Utilities	Constr.
14	2004 T-SPLOST	Intersection	SR 85 (South of Bernhard)						
15	2004 T-SPLOST	Intersection	Hampton Road(s) & SR 92						
16	2004 T-SPLOST	Intersection	Veterans Parkway @ SR 92						
17	2004 T-SPLOST	Intersection	County Line, Inman, S. Jeff Davis & N. Bridge Road Roundabout						
18	2017 SPLOST	Maintenance	Resurfacing - FY 2019 federal-aid (0016058)			na		na	
19	2017 SPLOST	Maintenance	Resurfacing - FY 2020 federal-aid (0016083)			na			
20	2004 T-SPLOST	New Capacity	EFB Roadway and Intersections						
21	2017 SPLOST	Operations / Safety	Kenwood Road School Zone						
22	2004 T-SPLOST Fayetteville	Operations / Safety	SR 85 Medians Phase 1 & 2 (SR 54 to SR 314)						
23	2004 T-SPLOST	Operations / Safety	Goza Road Realignment at Bernhard Rd						
24	2004 T-SPLOST	Operations / Safety	Kenwood Road Improvements						
25	Fayetteville	Path	Pedestrian Bridge over SR 54 at Hospital						
26	2017 SPLOST	Path	Redwine Rd Path Project (0012624)						

No.	Program	Category	Project Name	Concept	Design	ROW	Procure.	Utilities	Constr.
27	2017 SPLOST	Path	Starrs Mill Tunnel & Path (at Robinson Road)						
28	2017 SPLOST	Path	Camp Creek Timber Bridge along Redwine Road						
29	2004 T-SPLOST Fayetteville	Path	Veterans Parkway Ped Bridge @ Sandy Creek						
30	2017 SPLOST	Study	<i>SR 279 & Realignment with Corinth Corridor Study</i>		na	na	na	na	na
31	2017 SPLOST	Study	<i>Sandy Creek Road Corridor Study</i>		na	na	na	na	na
32	2017 SPLOST	Study	<i>Banks Road Corridor Study</i>		na	na	na	na	na
33	2017 SPLOST	Study	<i>Tyrone & Palmetto Roads Corridor Study</i>		na	na	na	na	na
34	2004 T-SPLOST PTC / Tyrone	Study	<i>SR 74 Corridor Study</i>		na	na	na	na	na

Hampton Road & SR 92 Intersections

(2004 SPLOST R-21)

- Review of concept
- Discussion on community outreach

TECHNICAL MEMORANDUM

To: Tyler Peek, P.E., District Traffic Engineer
Georgia Department of Transportation, District 3 (Thomaston)

From: Aimee S. Turner, P.E., PTOE

Date: April 23, 2020

**RE: SR 92 and Hampton Road, Woolsey, Fayette County, Georgia
Intersection Control Evaluation (ICE) Analysis and Concept Design**

For the Town of Woolsey, one of their top tier transportation projects identified is the offset Hampton Road intersection at State Route 92 (SR 92), Fayette County SPLOST Project #R-21. There are complaints of excessive queues on both SR 92 and Hampton Road N and Hampton Road S during the morning and afternoon peak hours due to vehicles having to traverse SR 92 for a short section before continuing on Hampton Road. Currently, the intersection geometry of Hampton Road at SR 92 is not designed to accommodate increasing traffic volumes safely; moreover, surrounding properties (potentially historic) impact improvements at the existing intersection location.

The Georgia Department of Transportation's (GDOT) Intersection Control Evaluation (ICE) Tool was used to identify the most effective intersection control for the two offset intersections. A review of the existing conditions was conducted to quantify existing parameters at the location including traffic operations, crash records, and a high-level environmental screening. Figure 1 shows the respective intersections and their existing traffic control.

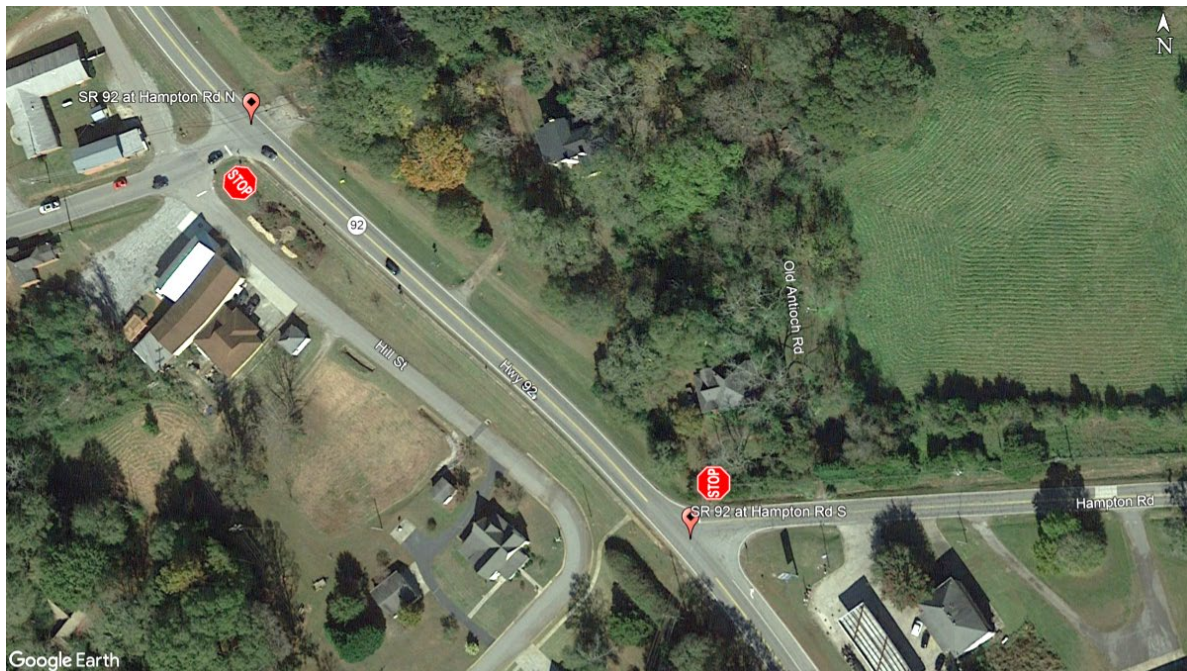
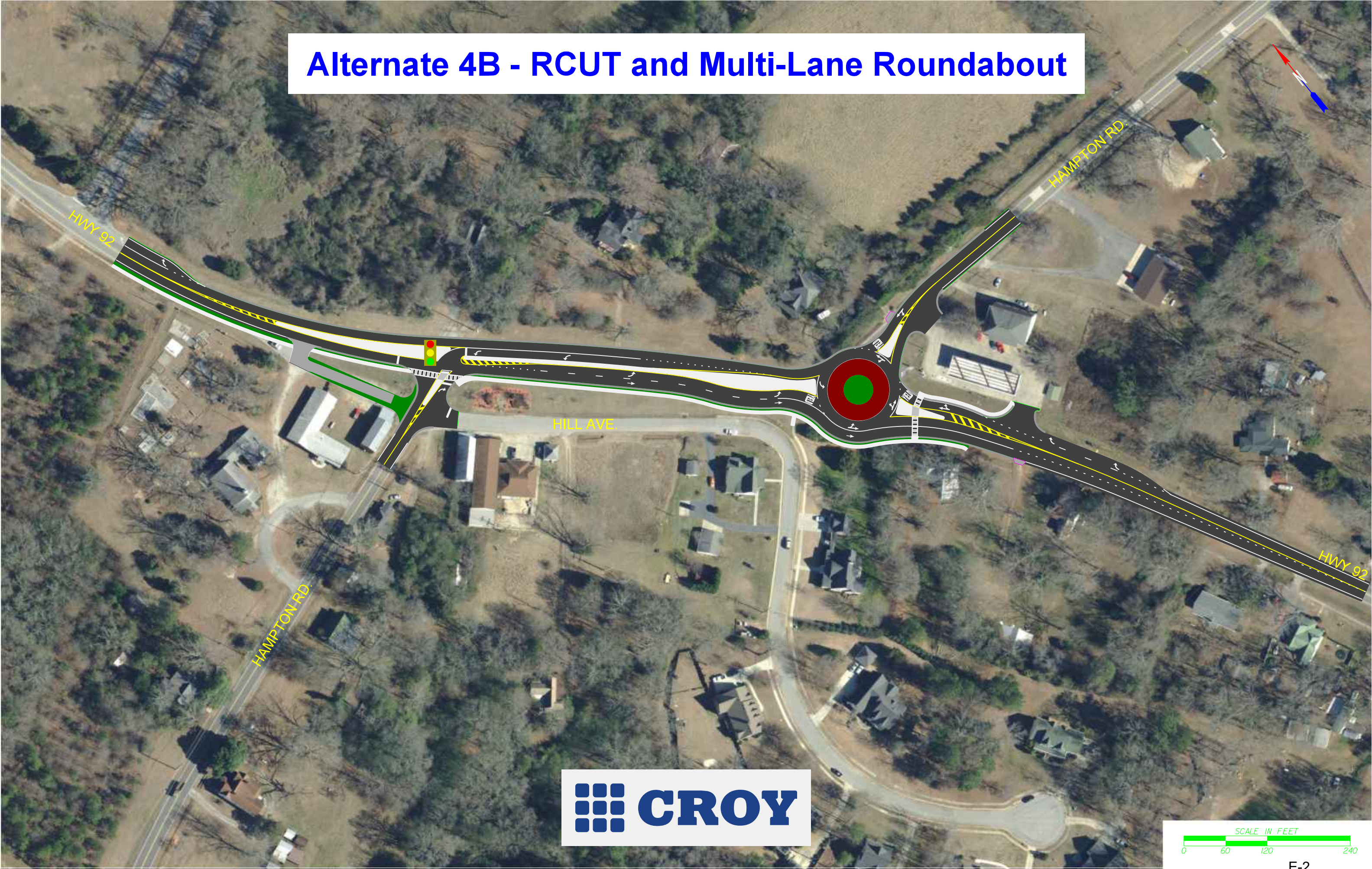

Figure 1: SR 92 and Hampton Road Intersection

Alternate 4B - RCUT and Multi-Lane Roundabout



Redwine Road, Bernhard Road and Peachtree Parkway Roundabout

(2017 SPLOST 17TAL)

- Final design for County approval
- Review of layout
- Path infrastructure

Peachtree Parkway

Redwine Road North

Redwine Road South

Bernhard

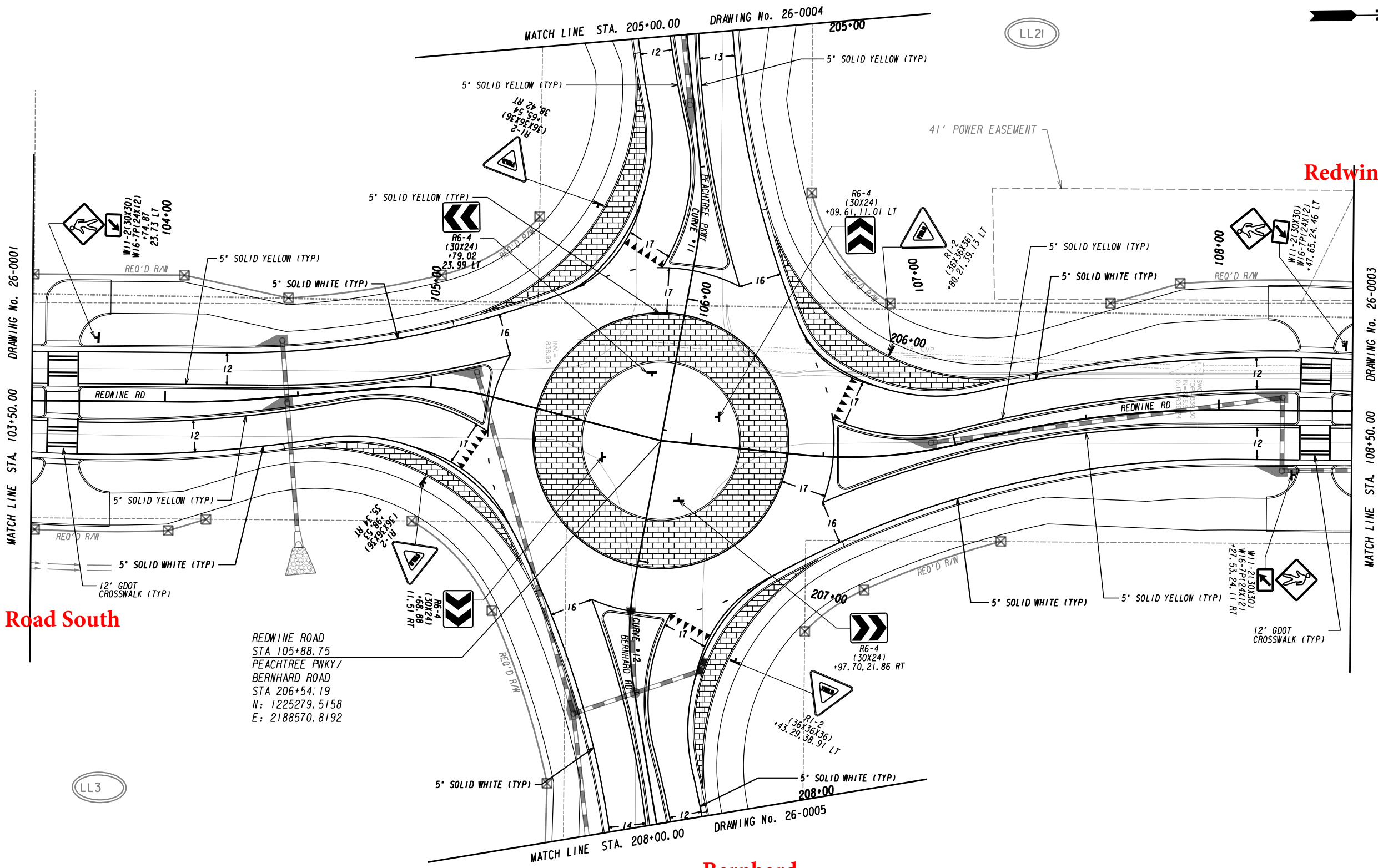

PROPERTY AND EXISTING R/W LINE	-----e-----
REQUIRED R/W LINE	-----C-----
CONSTRUCTION LIMITS	-----F-----
EASEMENT FOR CONSTR & MAINTENANCE OF SLOPES	[Hatched Box]
EASEMENT FOR CONSTR OF SLOPES	[Hatched Box]
EASEMENT FOR CONSTR OF DRIVES	[Hatched Box]

BEGIN LIMIT OF ACCESS.....BLA	-----o-----
END LIMIT OF ACCESS.....ELA	-----o-----
LIMIT OF ACCESS	-----o-----
REQ'D R/W & LIMIT OF ACCESS	-----o-----
ORANGE BARRIER FENCE	-----o-----
ESA - ENV. SENSITIVE AREA (SEE ERIT TABLE)	-----o-----

CROY ENGINEERING Engineers
Planners
Surveyors

200 NORTH COBB PARKWAY, BLDG. 400, SUITE 413
MARIETTA, GA 30062
PHONE: (770) 971-5407 FAX: (770) 971-0620



REVISION DATES	

SIGNING AND MARKING PLANS			
REDWINE RD, PEACHTREE PKWY INTERSECTION			
REDWINE ROAD			
CHECKED:	DATE:	DRAWING No.	
BACKCHECKED:	DATE:	26-0002	
CORRECTED:	DATE:		
VERIFIED:	DATE:		

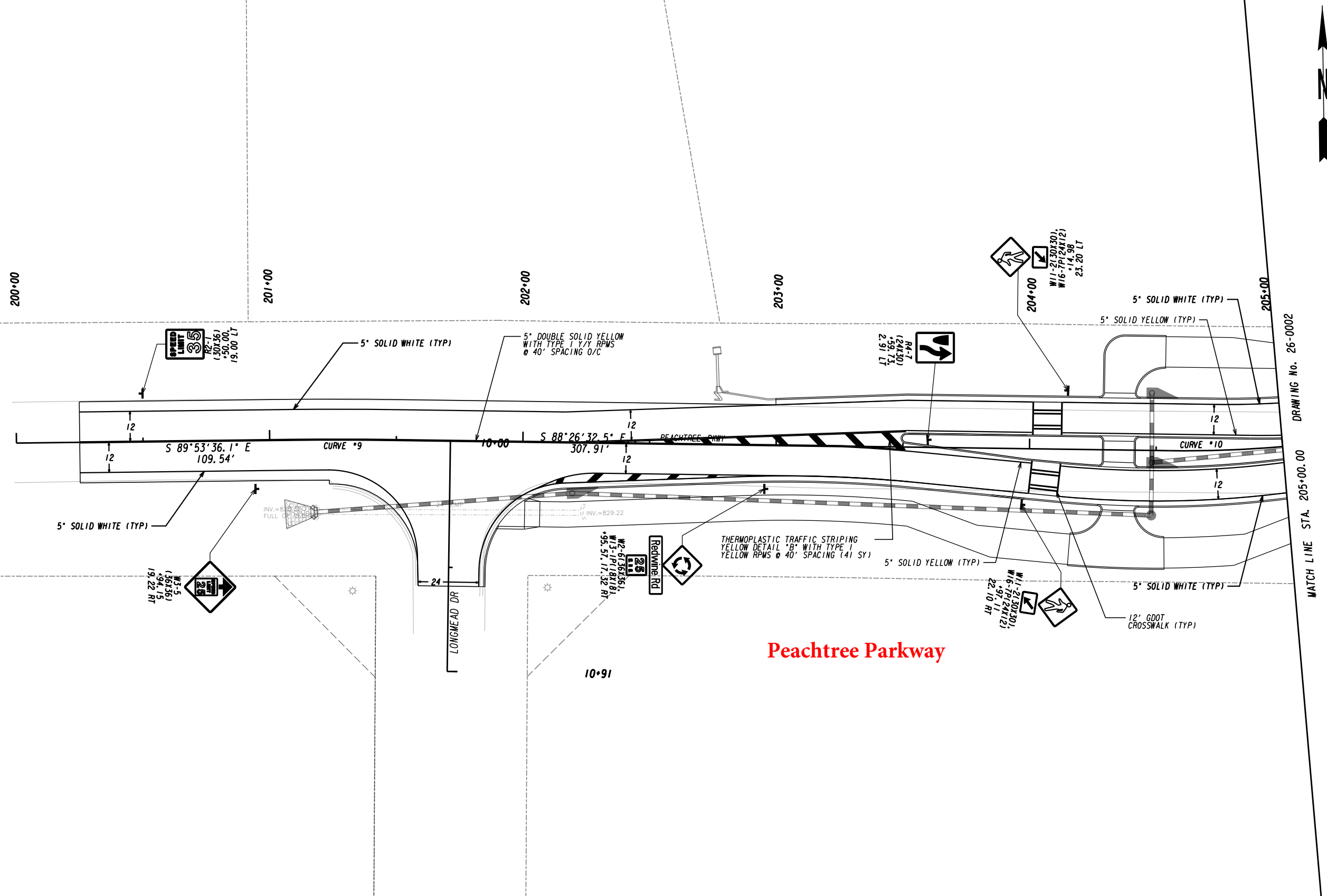

DRAWING No. 26-0002
MATCH LINE STA. 205+00.00

PROPERTY AND EXISTING R/W LINE
 REQUIRED R/W LINE
 CONSTRUCTION LIMITS
 EASEMENT FOR CONSTR
 & MAINTENANCE OF SLOPES
 EASEMENT FOR CONSTR OF SLOPES
 EASEMENT FOR CONSTR OF DRIVES

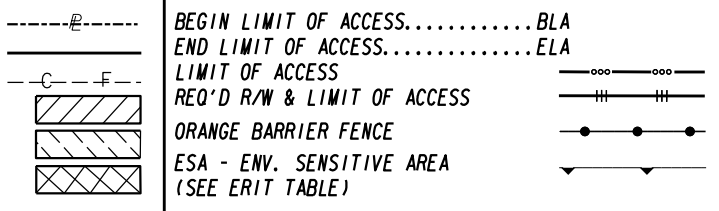

CROY ENGINEERING Engineers
 Planners
 Surveyors

200 NORTH COBB PARKWAY, BLDG. 400, SUITE 413
 MARIETTA, GA 30062
 PHONE: (770) 971-5407 FAX: (770) 971-0620

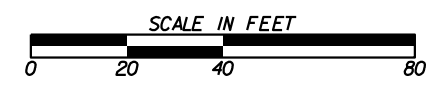

REVISION DATES	

SIGNING AND MARKING PLANS
 REDWINE RD, PEACHTREE PKWY INTERSECTION
 PEACHTREE PKWY EXT

CHECKED:	DATE:	DRAWING No.
BACKCHECKED:	DATE:	26-0004
CORRECTED:	DATE:	
VERIFIED:	DATE:	

DRAWING No. 26-0002
MATCH LINE STA. 108+50.00

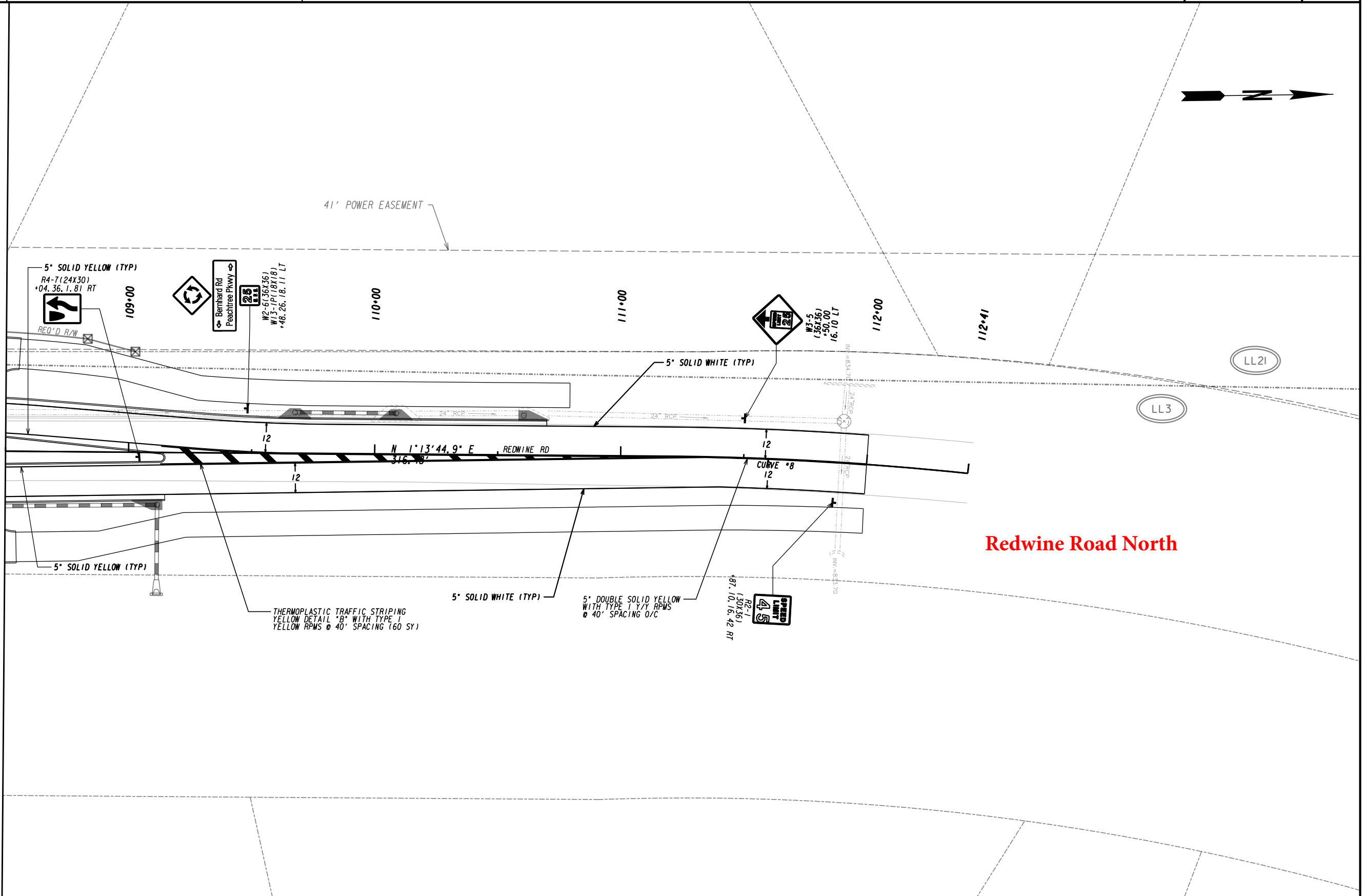

PROPERTY AND EXISTING R/W LINE
 REQUIRED R/W LINE
 CONSTRUCTION LIMITS
 EASEMENT FOR CONSTR
 & MAINTENANCE OF SLOPES
 EASEMENT FOR CONSTR OF SLOPES
 EASEMENT FOR CONSTR OF DRIVES

-----e-----
 ---C---F---
 [Hatched Box]
 [Hatched Box]
 [Hatched Box]

BEGIN LIMIT OF ACCESS.....BLA
 END LIMIT OF ACCESS.....ELA
 LIMIT OF ACCESS
 REQ'D R/W & LIMIT OF ACCESS
 ORANGE BARRIER FENCE
 ESA - ENV. SENSITIVE AREA
 (SEE ERIT TABLE)

[Symbol]
 [Symbol]
 [Symbol]
 [Symbol]

CROY ENGINEERING Engineers
 Planners
 Surveyors

200 NORTH COBB PARKWAY, BLDG. 400, SUITE 413
 MARIETTA, GA 30062
 PHONE: (770) 971-5407 FAX: (770) 971-0620

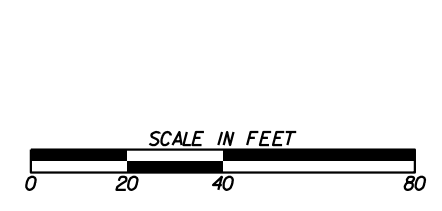

REVISION DATES	

SIGNING AND MARKING PLANS
 REDWINE RD, PEACHTREE PKWY INTERSECTION
 REDWINE ROAD

CHECKED:	DATE:	DRAWING No.
BACKCHECKED:	DATE:	26-0003
CORRECTED:	DATE:	
VERIFIED:	DATE:	

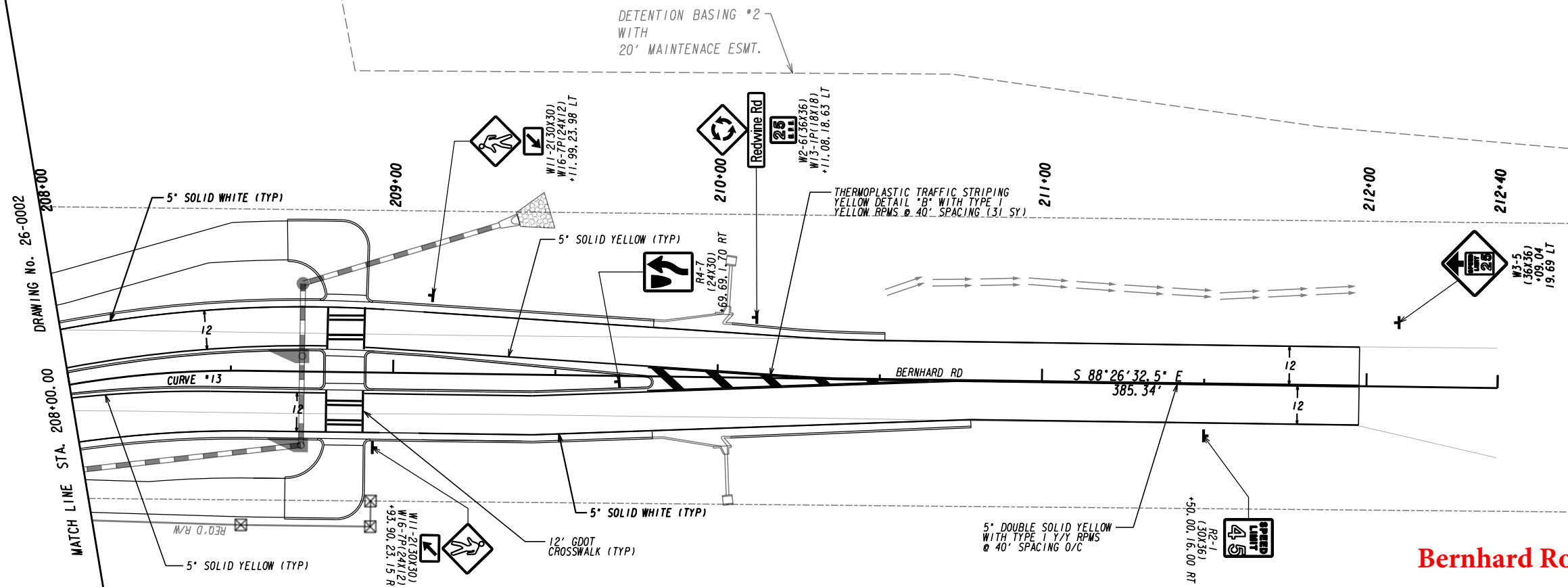

Bernhard Road

PROPERTY AND EXISTING R/W LINE	-----e-----
REQUIRED R/W LINE	-----f-----
CONSTRUCTION LIMITS	---C---F---
EASEMENT FOR CONSTR & MAINTENANCE OF SLOPES	
EASEMENT FOR CONSTR OF SLOPES	
EASEMENT FOR CONSTR OF DRIVES	

BEGIN LIMIT OF ACCESS.....BLA	
END LIMIT OF ACCESS.....ELA	
LIMIT OF ACCESS	
REQ'D R/W & LIMIT OF ACCESS	
ORANGE BARRIER FENCE	
ESA - ENV. SENSITIVE AREA (SEE ERIT TABLE)	

CROY ENGINEERING Engineers Planners Surveyors
 200 NORTH COBB PARKWAY, BLDG. 400, SUITE 413
 MARIETTA, GA 30062
 PHONE: (770) 971-5407 FAX: (770) 971-0620

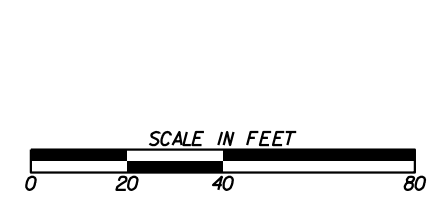

REVISION DATES	

SIGNING AND MARKING PLANS
 REDWINE RD, PEACHTREE PKWY INTERSECTION
 BERNHARD ROAD

CHECKED:	DATE:	DRAWING No.
BACKCHECKED:	DATE:	26-0005
CORRECTED:	DATE:	
VERIFIED:	DATE:	



Redwine Road South

BEGIN CONSTRUCTION
STA. 100+18.60
N: 1224712.3125
E: 2188551.4255

BEGIN PROJECT
STA. 100+00.00
N: 1224693.7250
E: 2188552.1330

1
N/F
PID: 060216025
VUONG HUNG PHU V.
LE LIEN T.
130 LONGMEAD DR
DB4362 PG528
PB31 PG30-103.104

2
N/F
PID: 060216026
LUSSOS ALEXANDER C
LUSSOS ANNA C
130 LONGMEAD DR
DB1855 PG475
PB31 PG30-103.104

3
N/F
PID: 060216027
SENGER ROBERT B
KATHLEEN
110 LONGMEAD DR
DB1519 PG617
PB31 PG30-103.104

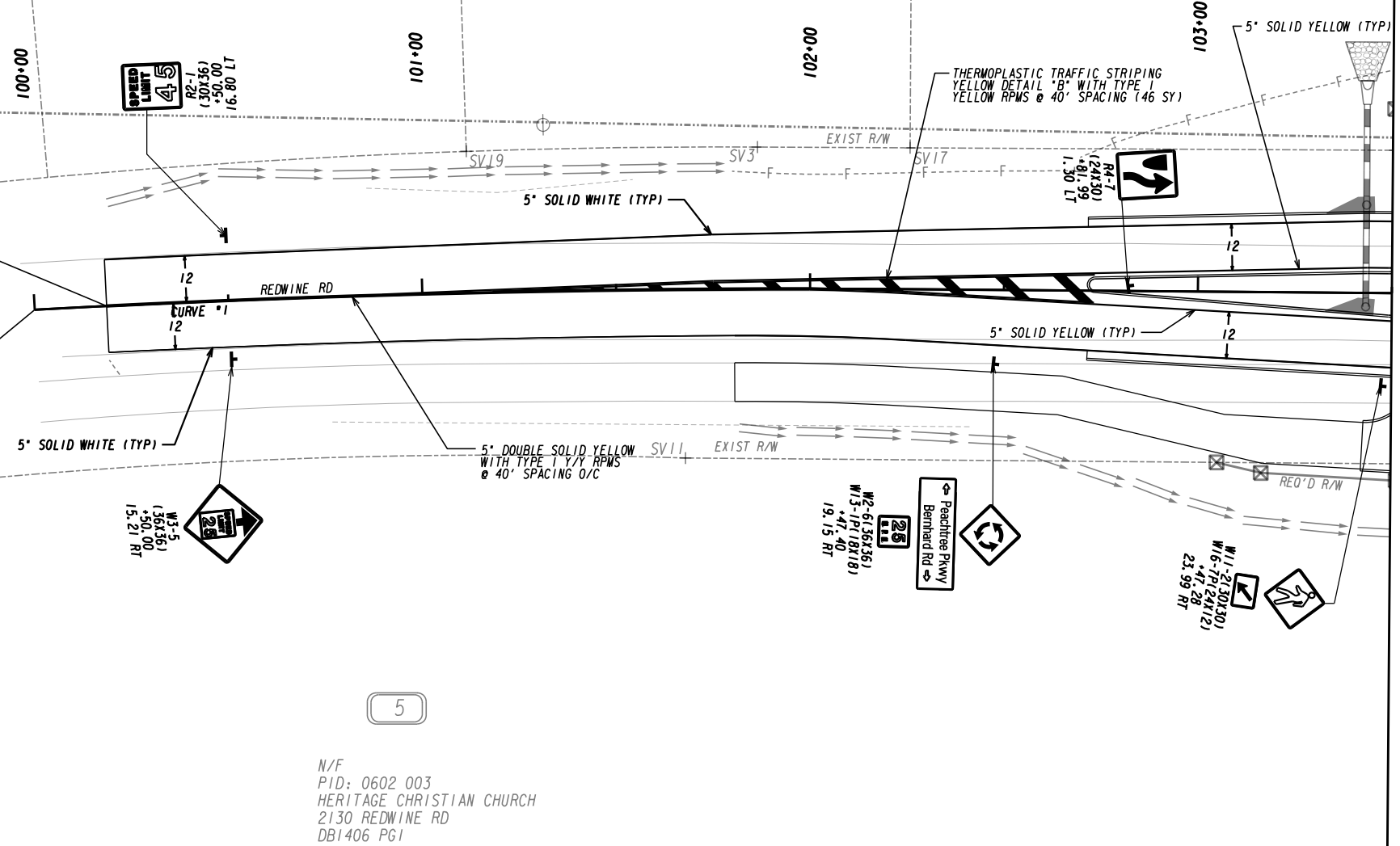

DRAWING No. 26-0002
MATCH LINE STA. 103+50

PROPERTY AND EXISTING R/W LINE	-----e-----
REQUIRED R/W LINE	-----f-----
CONSTRUCTION LIMITS	-----c-----
EASEMENT FOR CONSTR	-----f-----
& MAINTENANCE OF SLOPES	[Hatched Box]
EASEMENT FOR CONSTR OF SLOPES	[Hatched Box]
EASEMENT FOR CONSTR OF DRIVES	[Hatched Box]

BEGIN LIMIT OF ACCESS.....BLA	-----o-----
END LIMIT OF ACCESS.....ELA	-----o-----
LIMIT OF ACCESS	-----o-----
REQ'D R/W & LIMIT OF ACCESS	-----o-----
ORANGE BARRIER FENCE	-----o-----
ESA - ENV. SENSITIVE AREA	-----o-----
(SEE ERIT TABLE)	-----o-----

CROY ENGINEERING Engineers
Planners
Surveyors

200 NORTH COBB PARKWAY, BLDG. 400, SUITE 413
MARIETTA, GA 30062
PHONE: (770) 971-5407 FAX: (770) 971-0620

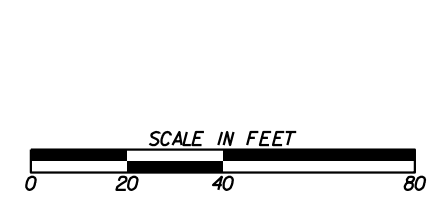

REVISION DATES	

SIGNING AND MARKING PLANS
REDWINE RD, PEACHTREE PKWY INTERSECTION
REDWINE ROAD

CHECKED:	DATE:	DRAWING No.
BACKCHECKED:	DATE:	26-0001
CORRECTED:	DATE:	
VERIFIED:	DATE:	

Atlanta Regional Commission 2nd Quarter Transportation Improvement Program (TIP) Update

- Does not include projects in Construction (CST) phase
- Ten Fayette Projects
 - (4) *GDOT Bridges*
 - (1) *FTA Allocation*
 - (1) *GDOT widening project – SR 85*
 - (1) *County resurfacing program (the FY 2019 program is in CST phase)*
 - (1) *County new capacity project – EFB*
 - (2) *Path projects – Redwine Road and Fayetteville Bridge at Hospital*

Atlanta Regional Commission Transportation Projects Report

AR-348A	SR 920 BRIDGE UPGRADE	Jurisdiction	Clayton County, Fayette County	Existing	Planned	Length (mi.)	Network Year
0016579	AT FLINT RIVER	Sponsor	GDOT	2	2	0.40	
Programmed		Service Type	Roadway / Bridge Upgrade	Analysis		Exempt from Air Quality Analysis (40 CFR 93)	
						LCI	<input type="checkbox"/>
						Flex	<input type="checkbox"/>

	Status	Year	Fund Type	Federal	State	Local	Bonds	Total
PE		2021	Surface Transportation Block Grant (STBG) Program Flex (GDOT)	\$520,000	\$130,000	\$0,000	\$0,000	\$650,000
ROW		2023	Local Jurisdiction/Municipality Funds	\$0,000	\$0,000	\$50,000	\$0,000	\$50,000
ROW		2023	Surface Transportation Block Grant (STBG) Program Flex (GDOT)	\$80,000	\$20,000	\$0,000	\$0,000	\$100,000
ALL		LR 2026-2030	General Federal Aid - 2026-2050	\$1,904,000	\$476,000	\$0,000	\$0,000	\$2,380,000
				\$2,504,000	\$626,000	\$50,000	\$0,000	\$3,180,000

Atlanta Regional Commission Transportation Projects Report

AR-5307-FA	FTA SECTION 5307/5340 FORMULA FUNDS ALLOCATION FOR FAYETTE COUNTY	Jurisdiction <input type="text" value="Fayette County"/>	Existing	Planned	Length (mi.)	Network Year
N/A		Sponsor <input type="text" value="Fayette County"/>	N/A	N/A	N/A	<input type="text"/>
Programmed		Service Type <input type="text" value="Transit / Formula Lump Sum"/>	Analysis <input type="text" value="Exempt from Air Quality Analysis (40 CFR 93)"/>			LCI <input type="checkbox"/>
						Flex <input type="checkbox"/>

	Status	Year	Fund Type	Federal	State	Local	Bonds	Total
CST	AUTH	2015	Transit Urbanized Area Formula Program	\$325,331	\$0,000	\$81,333	\$0,000	\$406,664
CST	AUTH	2016	Transit Urbanized Area Formula Program	\$322,431	\$0,000	\$80,608	\$0,000	\$403,039
CST	AUTH	2017	Transit Urbanized Area Formula Program	\$343,428	\$0,000	\$85,857	\$0,000	\$429,285
CST	AUTH	2018	Transit Urbanized Area Formula Program	\$360,121	\$0,000	\$90,030	\$0,000	\$450,151
CST	AUTH	2019	Transit Urbanized Area Formula Program	\$360,468	\$0,000	\$90,117	\$0,000	\$450,585
CST		2020	Transit Urbanized Area Formula Program	\$373,025	\$0,000	\$93,256	\$0,000	\$466,281
CST		2021	Transit Urbanized Area Formula Program	\$310,000	\$0,000	\$77,500	\$0,000	\$387,500
CST		2022	Transit Urbanized Area Formula Program	\$310,000	\$0,000	\$77,500	\$0,000	\$387,500
CST		2023	Transit Urbanized Area Formula Program	\$310,000	\$0,000	\$77,500	\$0,000	\$387,500
CST		2024	Transit Urbanized Area Formula Program	\$310,000	\$0,000	\$77,500	\$0,000	\$387,500
CST		2025	Transit Urbanized Area Formula Program	\$310,000	\$0,000	\$77,500	\$0,000	\$387,500
				\$3,634,804	\$0,000	\$908,701	\$0,000	\$4,543,505

Atlanta Regional Commission Transportation Projects Report

FA-085	SR 85 WIDENING	Jurisdiction	Fayette County	Existing	Planned	Length (mi.)	Network Year
321960-	FROM SR 92 TO GRADY AVENUE	Sponsor	GDOT	2	4	0.8	2030
Long Range		Service Type	Roadway / General Purpose Capacity	Analysis			LCI <input type="checkbox"/>
				In the Region's Air Quality Conformity Analysis			Flex <input type="checkbox"/>

	Status	Year	Fund Type	Federal	State	Local	Bonds	Total
PE	AUTH	1992	STP - Statewide Flexible (GDOT)	\$2,489,812	\$622,453	\$0,000	\$0,000	\$3,112,265
PE	AUTH	2014	STP - Urban (>200K) (ARC)	\$32,000	\$8,000	\$0,000	\$0,000	\$40,000
PE		LR 2026-2030	Transportation Funding Act (HB 170)	\$0,000	\$4,000,000	\$0,000	\$0,000	\$4,000,000
ALL		LR 2031-2040	Transportation Funding Act (HB 170)	\$0,000	\$62,278,741	\$0,000	\$0,000	\$62,278,741
				\$2,521,812	\$66,909,194	\$0,000	\$0,000	\$69,431,006

FA-100B	FAYETTE COUNTY RESURFACING PROGRAM - FY 2020	Jurisdiction	Fayette County	Existing	Planned	Length (mi.)	Network Year
0016083		Sponsor	Fayette County	N/A	N/A	25	
Programmed		Service Type	Roadway / Maintenance	Analysis			LCI <input type="checkbox"/>
				Exempt from Air Quality Analysis (40 CFR 93)			Flex <input type="checkbox"/>

	Status	Year	Fund Type	Federal	State	Local	Bonds	Total
CST		2020	Surface Transportation Block Grant (STBG) Program - Urban (>200K) (ARC)	\$3,070,844	\$0,000	\$767,711	\$0,000	\$3,838,555
CST		2020	Highway Infrastructure – 23 USC 133(b)(1)(A) Activities in Areas With a Population Over 200,000 (Z910)	\$1,115,671	\$0,000	\$278,918	\$0,000	\$1,394,589
				\$4,186,515	\$0,000	\$1,046,629	\$0,000	\$5,233,144

Atlanta Regional Commission Transportation Projects Report

FA-236	EAST FAYETTEVILLE BYPASS (NEW ALIGNMENT/WIDENING - INCLUDES ROUNDABOUT AT SOUTH JEFF DAVIS ROAD AND COUNTY LINE ROAD AND INTERSECTION IMPROVEMENTS AT INTERSECTION OF CORINTH ROAD AND CARTER ROAD)	Jurisdiction Fayette County	Existing 0/2	Planned 2	Length (mi.) 2.6	Network Year 2030
N/A	FROM CORINTH ROAD TO INTERSECTION OF COUNTY LINE ROAD AND COUNTY LINE COURT	Sponsor Fayette County				
Programmed		Service Type Roadway / General Purpose Capacity	Analysis In the Region's Air Quality Conformity Analysis			LCI <input type="checkbox"/>
						Flex <input type="checkbox"/>

	Status	Year	Fund Type	Federal	State	Local	Bonds	Total
PE	AUTH	2006	Local Jurisdiction/Municipality Funds	\$0,000	\$0,000	\$2,237,630	\$0,000	\$2,237,630
ROW	AUTH	2015	Local Jurisdiction/Municipality Funds	\$0,000	\$0,000	\$4,319,683	\$0,000	\$4,319,683
CST		2021	Local Jurisdiction/Municipality Funds	\$0,000	\$0,000	\$11,134,000	\$0,000	\$11,134,000
				\$0,000	\$0,000	\$17,691,313	\$0,000	\$17,691,313

FA-349	EBENEZER CHURCH ROAD BRIDGE REPLACEMENT	Jurisdiction Fayette County	Existing 2	Planned 2	Length (mi.) 0.13	Network Year
0008598	AT WHITEWATER CREEK	Sponsor GDOT				
Programmed		Service Type Roadway / Bridge Upgrade	Analysis Exempt from Air Quality Analysis (40 CFR 93)			LCI <input type="checkbox"/>
						Flex <input type="checkbox"/>

	Status	Year	Fund Type	Federal	State	Local	Bonds	Total
PE	AUTH	2016	STP - Urban (>200K) (ARC)	\$572,746	\$143,187	\$0,000	\$0,000	\$715,933
ROW		2020	Local Jurisdiction/Municipality Funds	\$0,000	\$0,000	\$160,000	\$0,000	\$160,000
UTL		2021	Local Jurisdiction/Municipality Funds	\$0,000	\$0,000	\$206,325	\$0,000	\$206,325
CST		2021	Surface Transportation Block Grant (STBG) Program - Urban (>200K) (ARC)	\$720,000	\$0,000	\$2,438,975	\$0,000	\$3,158,975
				\$1,292,746	\$143,187	\$2,805,300	\$0,000	\$4,241,233

Atlanta Regional Commission Transportation Projects Report

FA-352	REDWINE ROAD AND STARRS MILL SCHOOL COMPLEX MULTI-USE PATH	Jurisdiction	Fayette County	Existing	Planned	Length (mi.)	Network Year
0012624		Sponsor	Fayette County	N/A	N/A	1.5	
Programmed		Service Type	Last Mile Connectivity / Joint Bike-Ped Facilities		Analysis		LCI <input type="checkbox"/>
				Exempt from Air Quality Analysis (40 CFR 93)			Flex <input type="checkbox"/>

	Status	Year	Fund Type	Federal	State	Local	Bonds	Total
PE	AUTH	2014	STP - Urban (>200K) (ARC)	\$91,200	\$0,000	\$22,800	\$0,000	\$114,000
PE	AUTH	2019	Surface Transportation Block Grant (STBG) Program - Urban (>200K) (ARC)	\$56,064	\$0,000	\$14,016	\$0,000	\$70,080
ROW	AUTH	2017	Surface Transportation Block Grant (STBG) Program - Urban (>200K) (ARC)	\$200,000	\$0,000	\$50,000	\$0,000	\$250,000
CST	AUTH	2017	Surface Transportation Block Grant (STBG) Program - Urban (>200K) (ARC)	\$667,200	\$0,000	\$166,800	\$0,000	\$834,000
CST	AUTH	2017	Transportation Alternatives (Section 133(h)) - Urban (>200K) (ARC)	\$306,938	\$0,000	\$76,735	\$0,000	\$383,673
CST		2020	Surface Transportation Block Grant (STBG) Program - Urban (>200K) (ARC)	\$665,705	\$0,000	\$166,426	\$0,000	\$832,131
				\$1,987,107	\$0,000	\$496,777	\$0,000	\$2,483,884

Atlanta Regional Commission Transportation Projects Report

FA-353	FAYETTEVILLE MULTI-USE BRIDGE AND PATHS	Jurisdiction	Fayette County	Existing	Planned	Length (mi.)	Network Year
0012878		Sponsor	Fayette County	N/A	N/A	0.8	
Programmed		Service Type	Last Mile Connectivity / Sidepaths and Trails	Analysis		Exempt from Air Quality Analysis (40 CFR 93)	LCI <input type="checkbox"/> Flex <input type="checkbox"/>

	Status	Year	Fund Type	Federal	State	Local	Bonds	Total
PE	AUTH	2014	TAP - Urban (>200K) (ARC)	\$749,000	\$0,000	\$187,250	\$0,000	\$936,250
PE	AUTH	2016	TAP - Urban (>200K) (ARC)	\$320,000	\$0,000	\$80,000	\$0,000	\$400,000
ROW	AUTH	2017	Transportation Alternatives (Section 133(h)) - Urban (>200K) (ARC)	\$672,000	\$0,000	\$168,000	\$0,000	\$840,000
UTL		2021	Local Jurisdiction/Municipality Funds	\$0,000	\$0,000	\$100,000	\$0,000	\$100,000
CST		2021	Surface Transportation Block Grant (STBG) Program - Urban (>200K) (ARC)	\$2,472,434	\$0,000	\$722,756	\$0,000	\$3,195,190
				\$4,213,434	\$0,000	\$1,258,006	\$0,000	\$5,471,440

FA-355	SR 85 BRIDGE REPLACEMENT	Jurisdiction	Fayette County	Existing	Planned	Length (mi.)	Network Year
0013734	AT WHITEWATER CREEK	Sponsor	GDOT	2	2	0.4	
Programmed		Service Type	Roadway / Bridge Upgrade	Analysis		Exempt from Air Quality Analysis (40 CFR 93)	LCI <input type="checkbox"/> Flex <input type="checkbox"/>

	Status	Year	Fund Type	Federal	State	Local	Bonds	Total
PE	AUTH	2016	Surface Transportation Block Grant (STBG) Program Flex (GDOT)	\$672,800	\$168,200	\$0,000	\$0,000	\$841,000
ROW		2021	Surface Transportation Block Grant (STBG) Program Flex (GDOT)	\$200,000	\$50,000	\$0,000	\$0,000	\$250,000
UTL		2023	Surface Transportation Block Grant (STBG) Program Flex (GDOT)	\$46,720	\$11,680	\$0,000	\$0,000	\$58,400
CST		2023	Surface Transportation Block Grant (STBG) Program Flex (GDOT)	\$2,852,886	\$713,222	\$0,000	\$0,000	\$3,566,108
				\$3,772,406	\$943,102	\$0,000	\$0,000	\$4,715,508

Atlanta Regional Commission Transportation Projects Report

FA-358	COASTLINE ROAD BRIDGE REPLACEMENT	Jurisdiction	Fayette County	Existing	Planned	Length (mi.)	Network Year
0015647	AT CSX RAILROAD	Sponsor	GDOT	2	2	0.4	
Programmed		Service Type	Roadway / Bridge Upgrade	Analysis			LCI <input type="checkbox"/>
				Exempt from Air Quality Analysis (40 CFR 93)			Flex <input type="checkbox"/>

	Status	Year	Fund Type	Federal	State	Local	Bonds	Total
PE	AUTH	2018	Surface Transportation Block Grant (STBG) Program Off-System Bridge	\$400,000	\$100,000	\$0,000	\$0,000	\$500,000
ROW	AUTH	2018	STATE (40301)	\$0,000	\$0,000	\$0,000	\$83,500	\$83,500
ROW		2021	Surface Transportation Block Grant (STBG) Program Off-System Bridge	\$66,800	\$16,700	\$0,000	\$0,000	\$83,500
CST		2024	Surface Transportation Block Grant (STBG) Program Off-System Bridge	\$880,000	\$220,000	\$0,000	\$0,000	\$1,100,000
				\$1,346,800	\$336,700	\$0,000	\$83,500	\$1,767,000

COVID-19 and Transportation

ARC's Perspective

Transportation Coordinating Committee (TCC)

Virtual Meeting

April 17, 2020



For Major Commuting Corridors Average Daily Traffic Volumes are Down Significantly

Corridor	Week of April 8 2019	Week of April 6 2020	Difference
I-75 SB near Delk Rd	130,873	79,378	-39.35%
I-85 SB near Beaver Ruin	143,080	98,890	-30.88%
GA 400 SB near Pitts Rd	87,740	41,858	-52.29%
I-75/85 SB at 5th St	149,253	89,361	-40.13%
I-20 WB at Columbia Dr	66,345	40,064	-39.61%
I-20 EB near MLK Jr Dr	80,916	43,944	-45.69%
I-75 NB near I-675	84,184	52,223	-37.97%

Source: GDOT Technical Analysis

Economic Conditions Can Have Long-Lasting Impacts on Vehicle Miles of Travel (VMT) Levels. During the Last Recession, National VMT did not Return to 2008 Pre-Recession Levels Until 2015 (7 years)

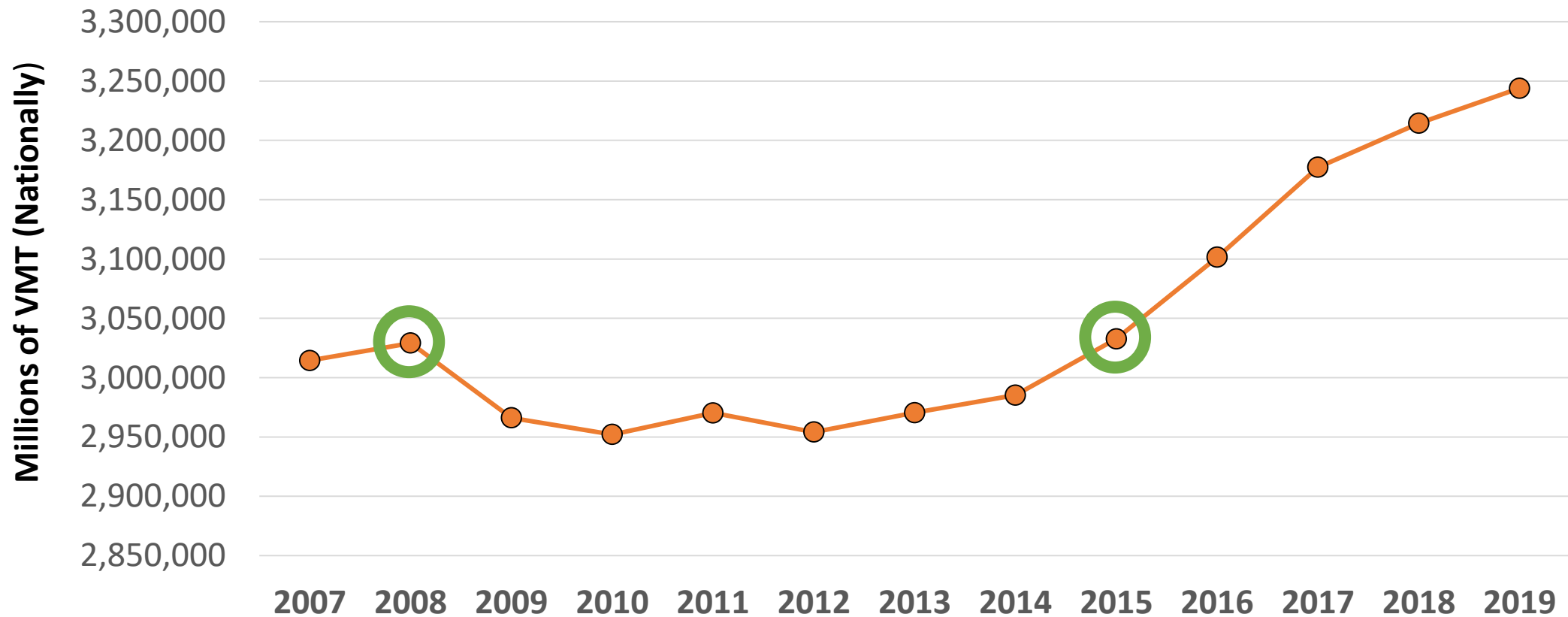

Source: FHWA

https://www.fhwa.dot.gov/policyinformation/travel_monitoring/20jantvt/page2.cfm

Retail/Recreational Travel Reductions Range From 37% to 61%

Location	Estimated Travel Reductions Retail & Recreational	Location	Estimated Travel Reductions Retail & Recreational
<i>Statewide</i>	-50%	Forsyth	-54%
Barrow	-45%	Fulton	-59%
Carroll	-42%	Gwinnett	-54%
Cherokee	-47%	Henry	-51%
Clayton	-40%	Newton	-37%
Cobb	-55%	Paulding	-43%
Coweta	-53%	Pike	-54%
Dawson	-61%	Rockdale	-46%
DeKalb	-52%	Spalding	-39%
Douglas	-47%	Walton	-38%
Fayette	-48%		

Source: Google COVID-19 Community Mobility Report

https://www.gstatic.com/covid19/mobility/2020-04-05_US_Georgia_Mobility_Report_en.pdf

Workplaces Travel Reductions Range From 35% to 51%

Location	Estimated Travel Reductions Workplaces	Location	Estimated Travel Reductions Workplaces
<i>Statewide</i>	-42%	Forsyth	-49%
Barrow	-42%	Fulton	-48%
Carroll	-35%	Gwinnett	-50%
Cherokee	-44%	Henry	-48%
Clayton	-40%	Newton	-42%
Cobb	-48%	Paulding	-42%
Coweta	-43%	Pike	-42%
Dawson	-37%	Rockdale	-42%
DeKalb	-47%	Spalding	-41%
Douglas	-42%	Walton	-40%
Fayette	-51%		

Source: Google COVID-19 Community Mobility Report

https://www.gstatic.com/covid19/mobility/2020-04-05_US_Georgia_Mobility_Report_en.pdf

Many of the Major Regional Travel Corridors

Estimated Vehicle Miles Traveled (VMT) in Georgia

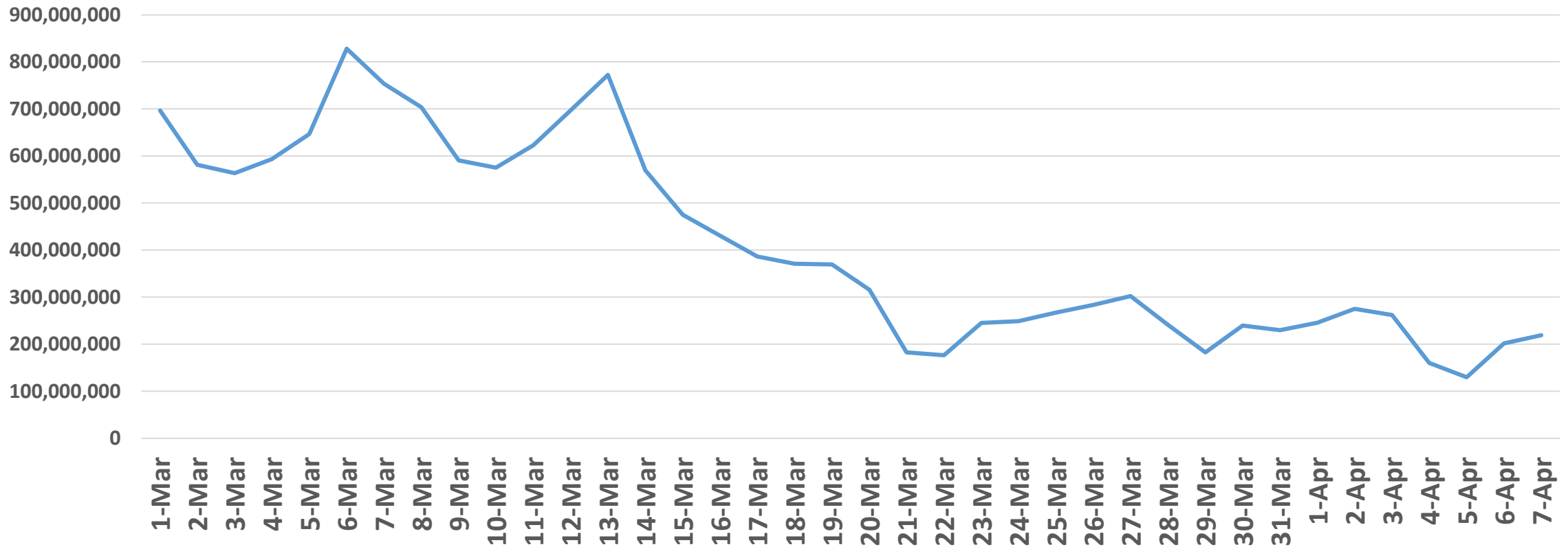

NOTE: VMT estimates will not match up with FHWA HPMS data due to differing methodologies.

Source: Streetlight.com - <https://www.streetlightdata.com/VMT-monitor-by-county/#emergency-map-response>

Key Points from Early Travel Data Analysis

- Declines in travel associated with certain trip types (retail, workplace) indicate that major economic disruptions have occurred.
- Economic disruptions historically have a major impact on VMT, with reductions in VMT lowering revenues to both state motor fuel excise tax receipts and the national Highway Trust Fund.
- The national Highway Trust Fund is the primary source of federal funding for all transportation project types – including transit.
- ARC will monitor both motor fuel and sales tax receipts and provide updates as data is released over the next month.

Background Information on the Prior 2009 ARRA Federal Stimulus Package

- The Great Recession's Impacts on SPLOST Collections
- Effectiveness of Transportation Infrastructure as an Economic Stimulus?
- Initial Thoughts for Maximizing the Effectiveness of a Possible Federal Stimulus Bill (Transportation Element)

The Great Recession Had Long Term Impacts

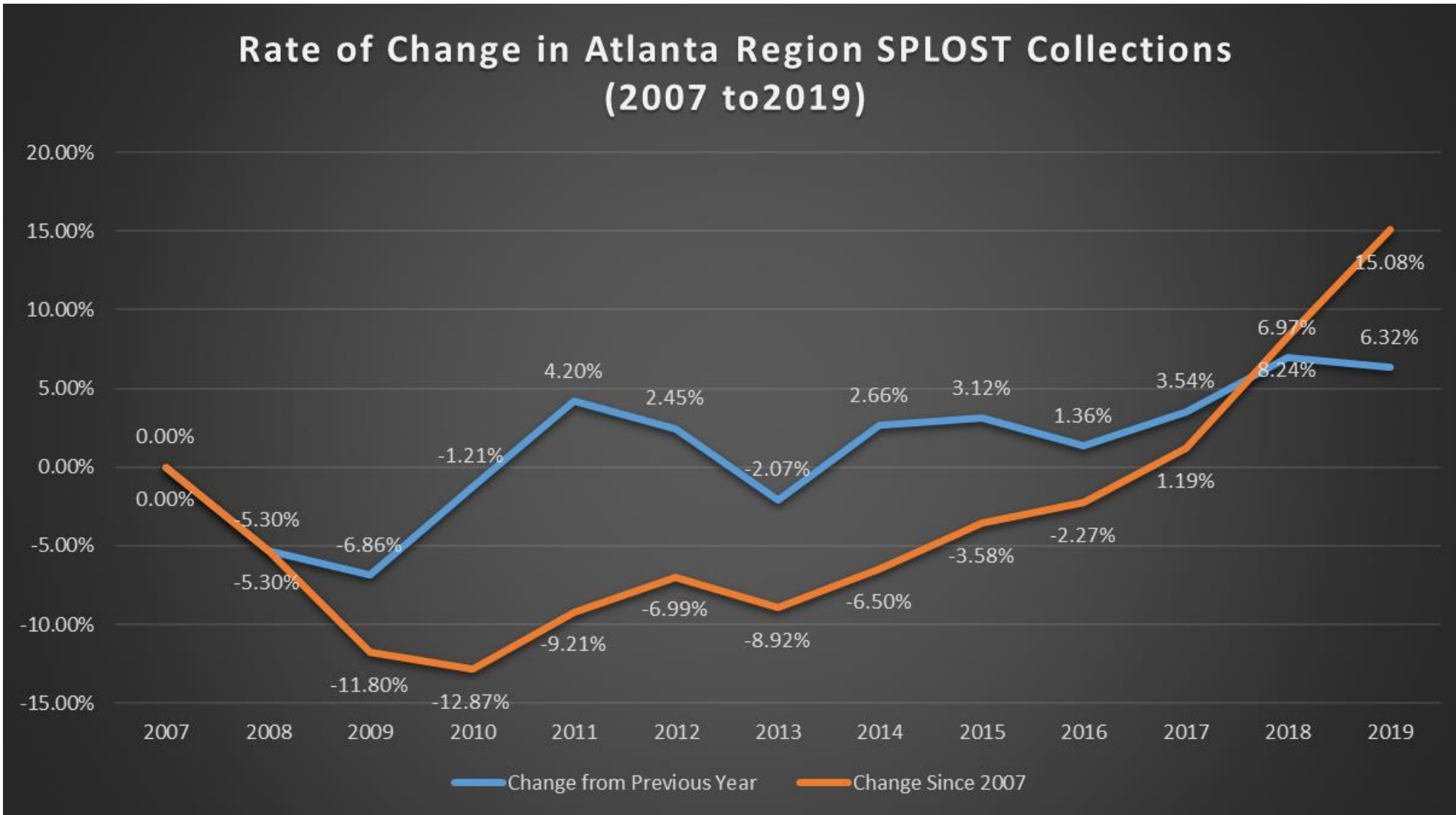

Local Coordination to Identify Potential Stimulus Projects that are “Design Ready”

- Scan existing TIP projects for readiness (GDOT ROW and Let Status Reports)
- Identify projects of all scopes and sizes – initially focus on low hanging fruit and urgent safety improvements
- Identify completed scoping studies (draft or approved Concept Reports)